

ASSEMBLY INSTRUCTIONS:

- SEE APPLICABLE S570 SERIES SECTION I. FOR INSTRUCTIONS.

- REFERENCE APPLICABLES570 SERIES FOR ADDITIONAL STANDARDS AND INSTRUCTIONS THAT MAY APPLY.

- ALL FASTENERS, FITTINGS AND PLUGS TO BE TORQUED PER S574 UNLESS OTHERWISE SPECIFIED.

- NOTE A: TORQUE MOUNTING BOLTS TO 57-68 N-m "AS RECEIVED" OR 47-56 N-m "LUBRICATED"

BILL OF MATERIAL

ITEM NO.	QTY.	PART NO.	DESCRIPTION
1	2	1020542A	VALVE
2	1	P4885A	PLATE
3	4	M422B	SCREW, DRIVE
4	1	1020413A	VALVE ASSY, CONTROL
5	1	MA1052U	SCREW, SOCKET HEAD
6	3	MA1052B	SCREW, SOCKET HEAD
7	1	PM1349AA	WASHER
8	1	M2006C	SCREW, HEX HEAD

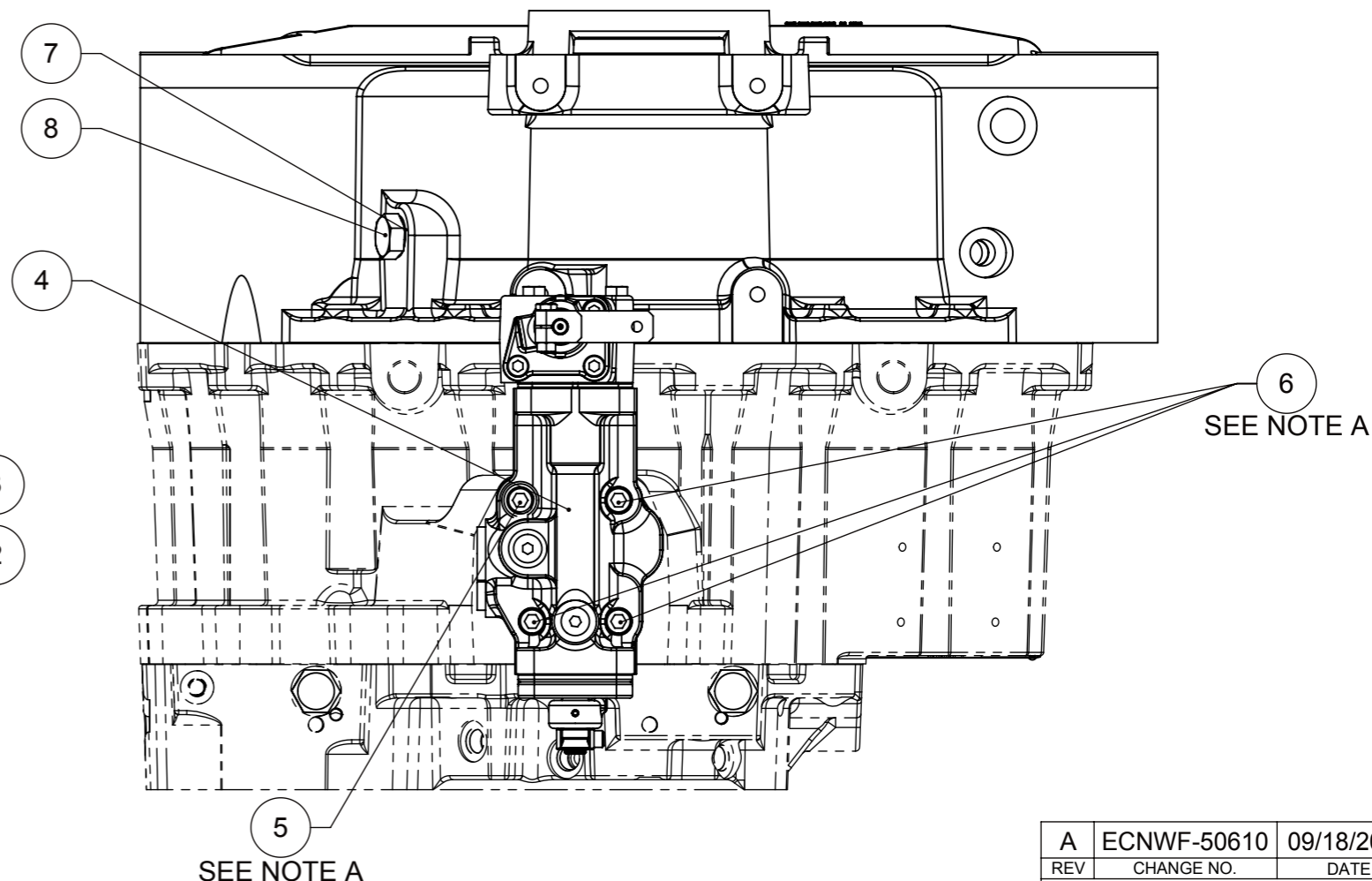
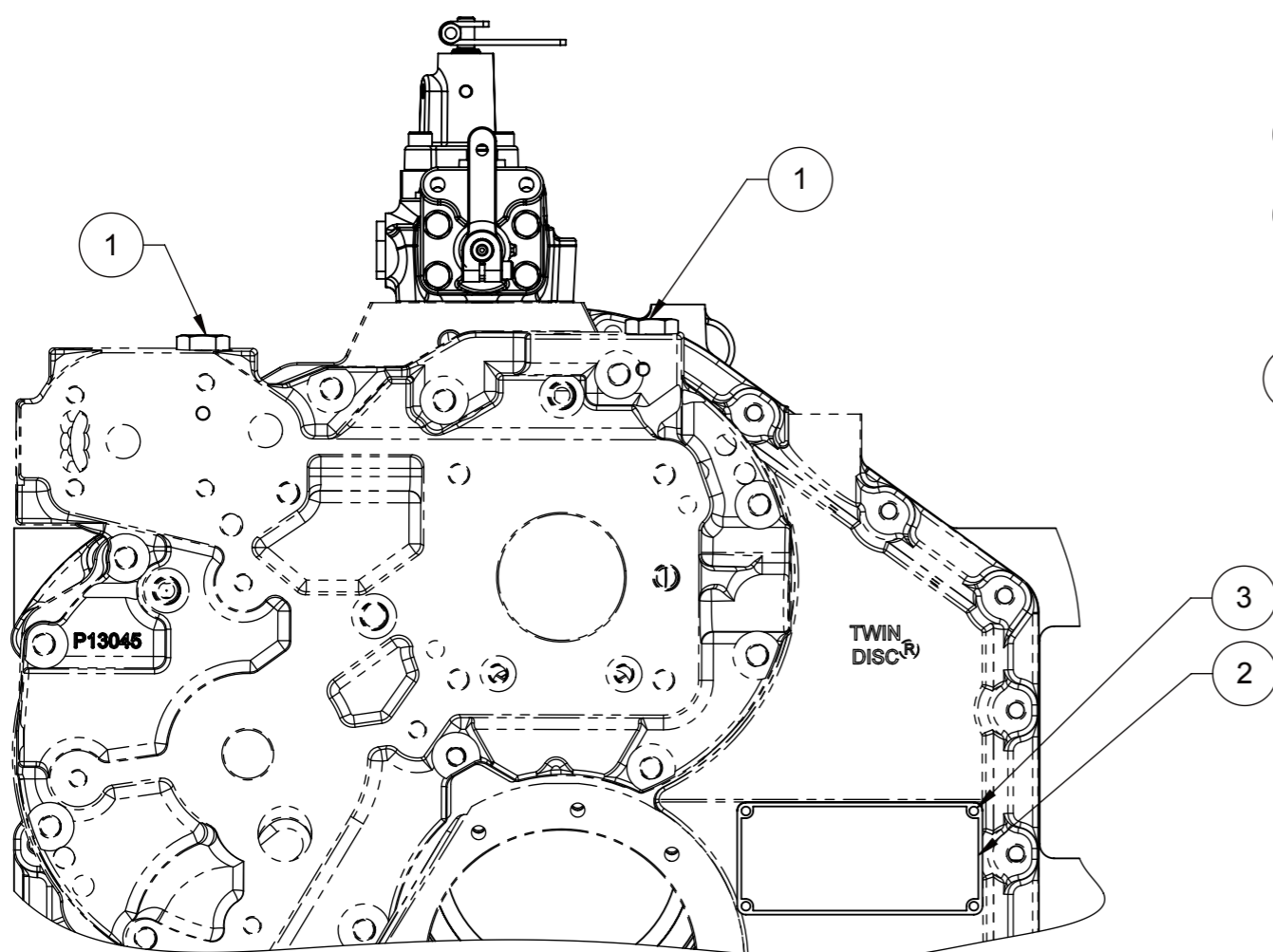

APPLICABLE MODELS:

MG-5136A PER 1027557 ASSEMBLY INSTRUCTIONS: S570DX

MG-5136RV PER 1027561 ASSEMBLY INSTRUCTIONS: S570DX

MG-5136SC PER 1027560 ASSEMBLY INSTRUCTIONS: S570DW

FIRST USE ASSEMBLY: 1027557	WEIGHT: 10.78kg	<p>THIRD ANGLE PROJECTION</p>
FIRST USE MODEL: MG-5136A	WR ² : kg-m ²	
SIMILAR TO:		
METRIC		
<small>NOTICE! THIS PRINT CONTAINS PROPRIETARY INFORMATION AND IS NOT TO BE USED IN ANY MANNER DETRIMENTAL TO THE INTEREST OF TWIN DISC, INCORPORATED. THIS NOTICE IS NOT INTENDED TO NULLIFY OR LIMIT RIGHTS GRANTED TO THE U.S. GOVERNMENT OR OTHERS BY CONTRACT.</small>		

UNLESS OTHERWISE SPECIFIED MACHINED DIMENSIONS
 X ±0.75
 X.X ±0.25
 X.XX ±0.13
 ALL ANGULAR TOLERANCES ±1°
 GEOMETRIC TOLERANCING PER ASME Y14.5M 1994

MATERIAL:
 HEAT TREAT:
 DESCRIPTION:
GROUP, CONTROL MECHANICAL VALVE WITH TROLL

DATE: 09/27/2012
 SCALE: 1:4
 DRAWN BY: LT
 CHECKED BY: JMF
 APPROVED BY: ALC

A	ECNWF-50610	09/18/2015
REV	CHANGE NO.	DATE
<p>RACINE, WI 53403 - USA</p>		
1027559		
DWG SIZE: A3	SHEET: 1 OF 1	REV: A