

central input rotation

input assy IT1071030B  
housing SAE 3 flywheel 11.5"

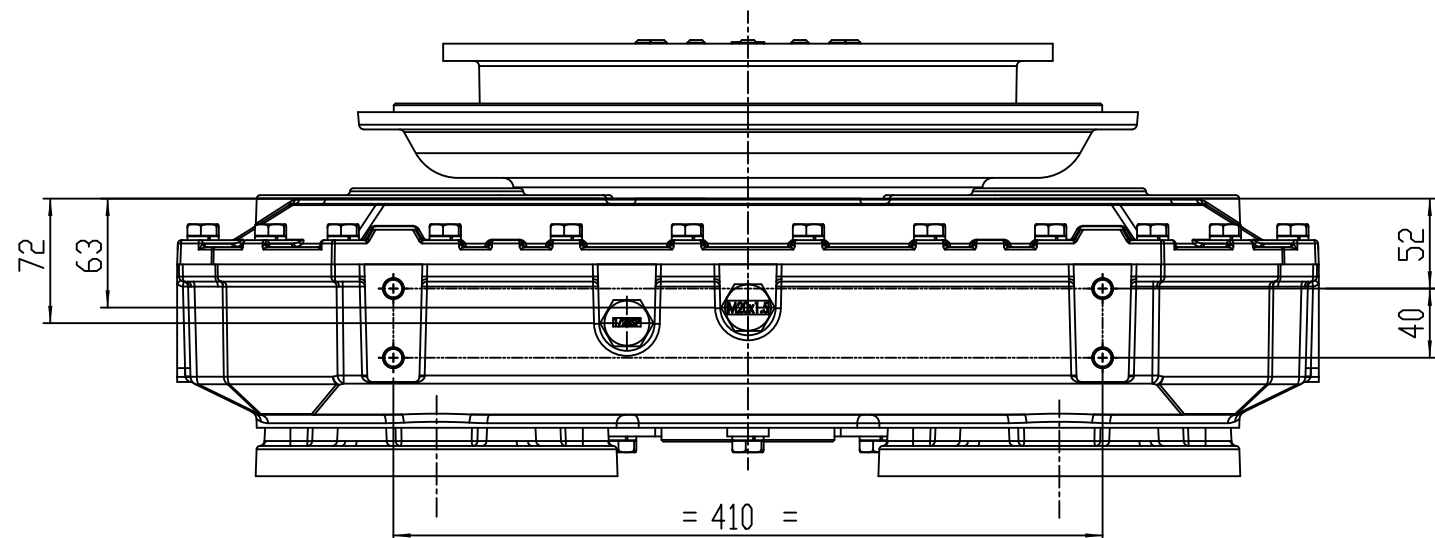
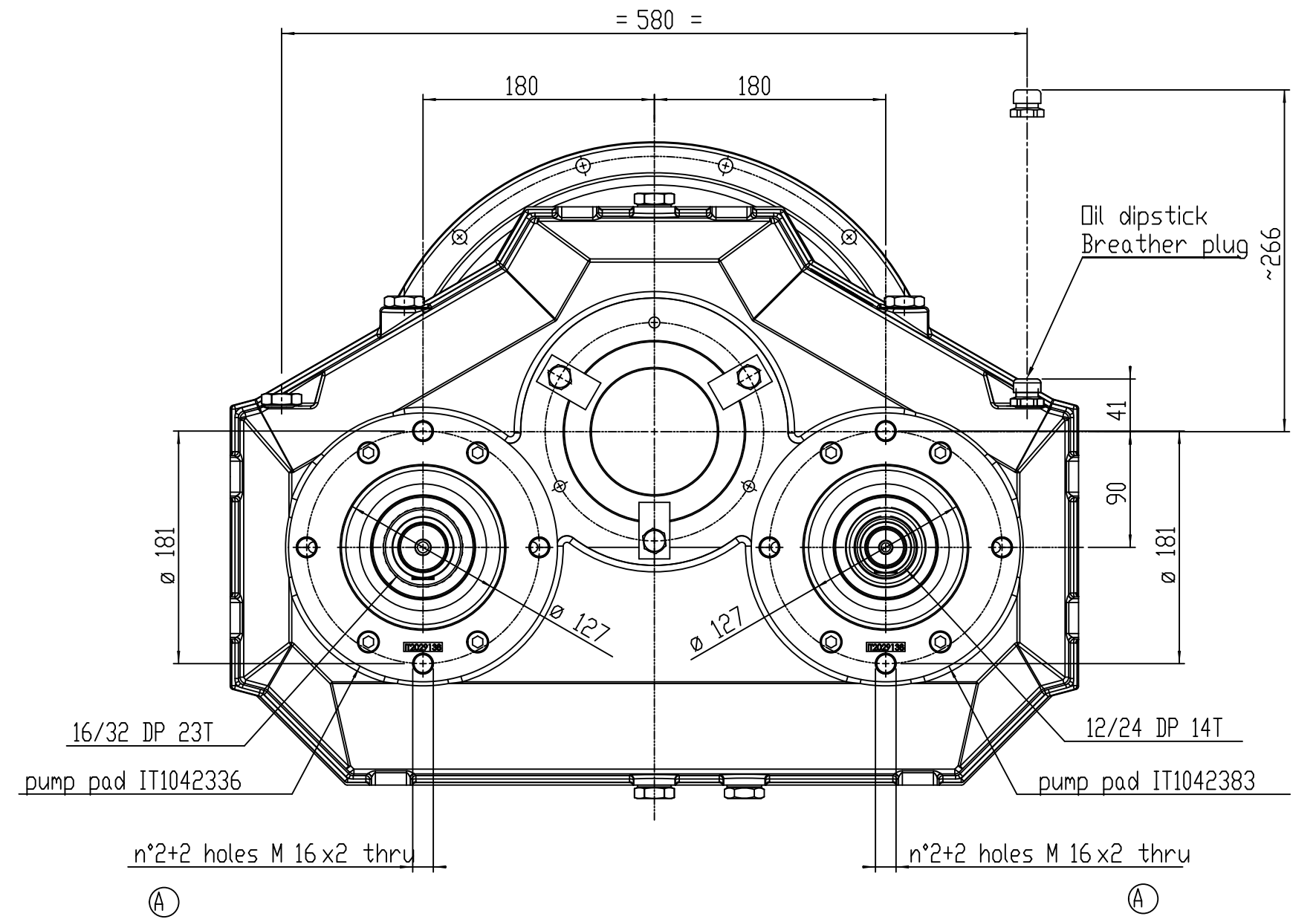
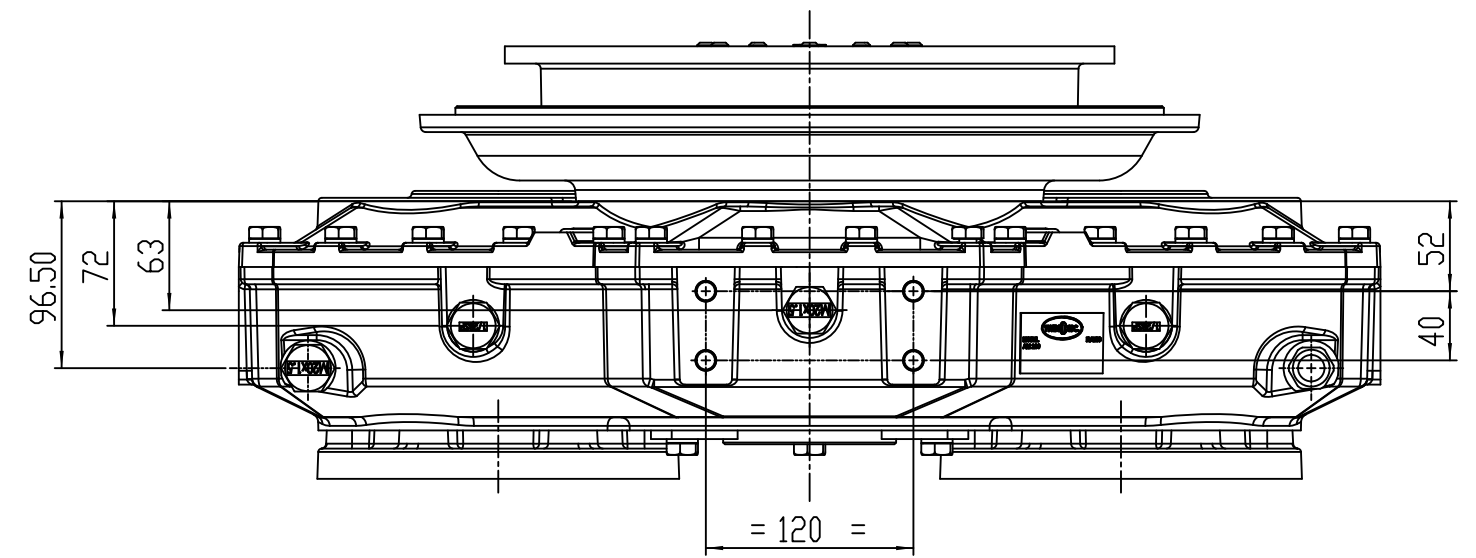
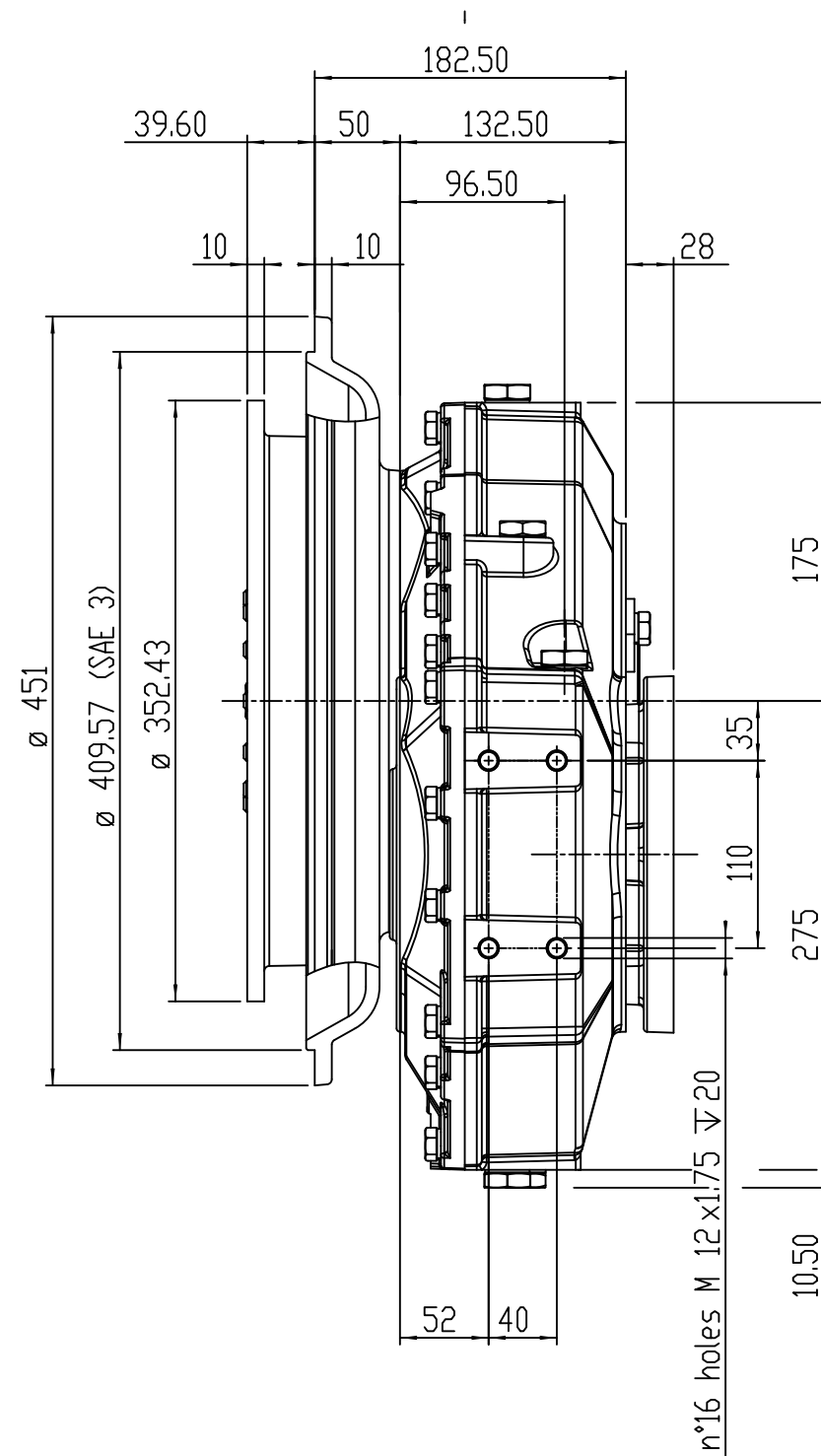
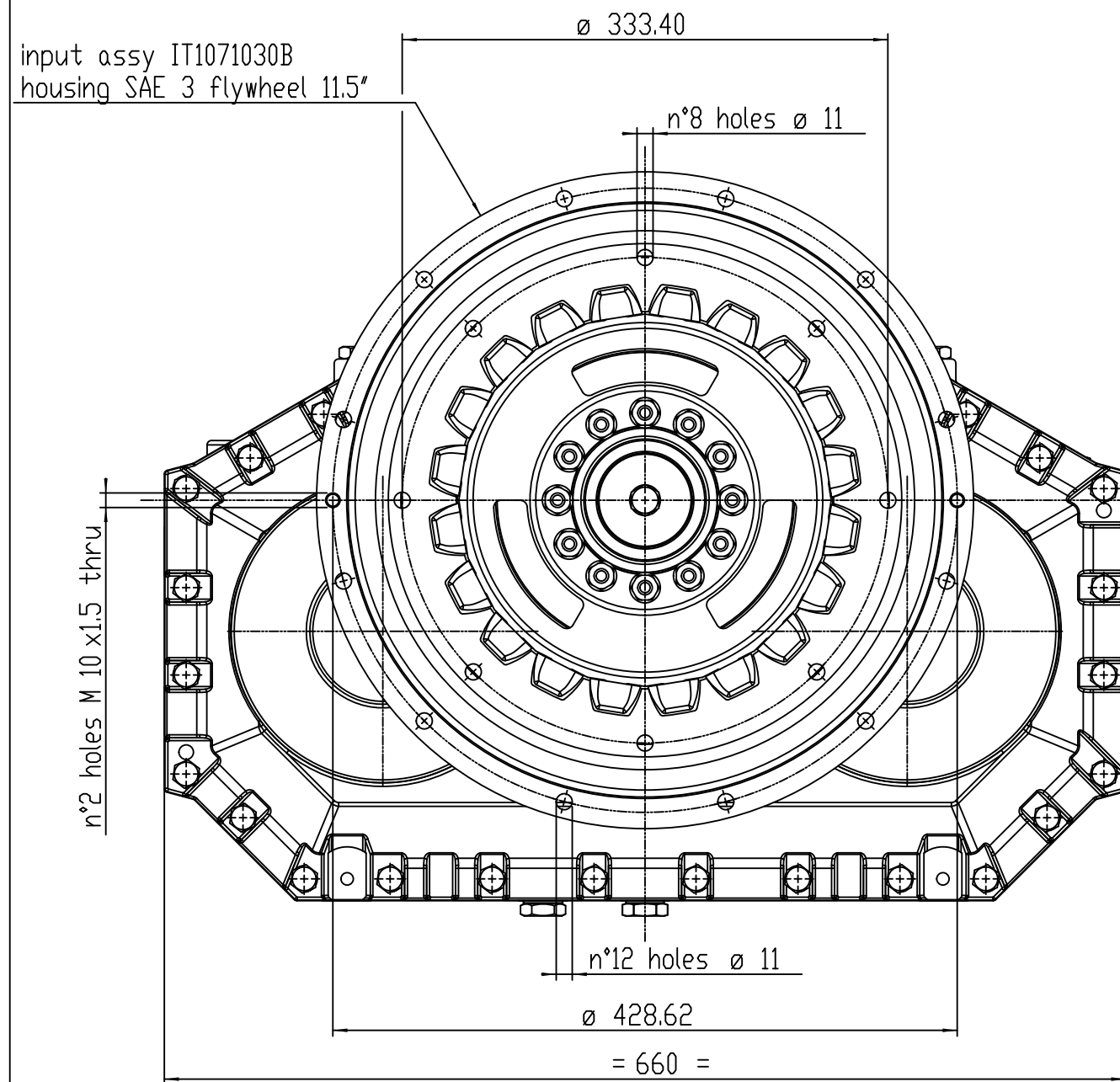

Drawing and 3D model are valid for all ratios

FIRST USE ASSEMBLY:		WEIGHT:	kg	THIRD ANGLE PROJECTION	MATERIAL:	DATE:	19-Jun-14
FIRST USE MODEL:		M · 2	kg-m <sup>2</sup>		BEAT TREAT:	SCALE:	1:4
SIMILAR TID		METRIC		UNLESS OTHERWISE SPECIFIED MACHINED DIMENSIONS I ± 0.75 II ± 0.25 III ± 0.13	DESCRIPTION:	Checked by:	Rosso
<small>METRIC: THIS PRINT CONTAINS PROPRIETARY INFORMATION AND IS NOT TO BE USED IN ANY MANNER BENEFICIAL TO THE INTEREST OF TWIN DISC, INCORPORATED.</small> <small>THIS METRIC IS NOT INTENDED TO WAIVE OR LIMIT RIGHTS GRANTED TO THE U.S. GOVERNMENT OR OTHERS BY CONTRACT.</small>		<small>ALL ANGULAR TOLERANCES ±1° GEOMETRIC TOLERANCING PER ASME Y14.5M 1994</small>		Installation pump drive, AM 230 BOM n°1029016A	APPROVED BY:	Pezzini	1029017A
				APPROVED BY: Guzzinati		DATE:	06/24/2015
				CHANGE NDL DATE		TWIN DISC SRL - ITALY SHEET: 1 OF 1 REV: A	ECNWF-25233 DATE