

central input rotation

input assy IT1071025B  
housing SAE 2 flywheel 11.5"

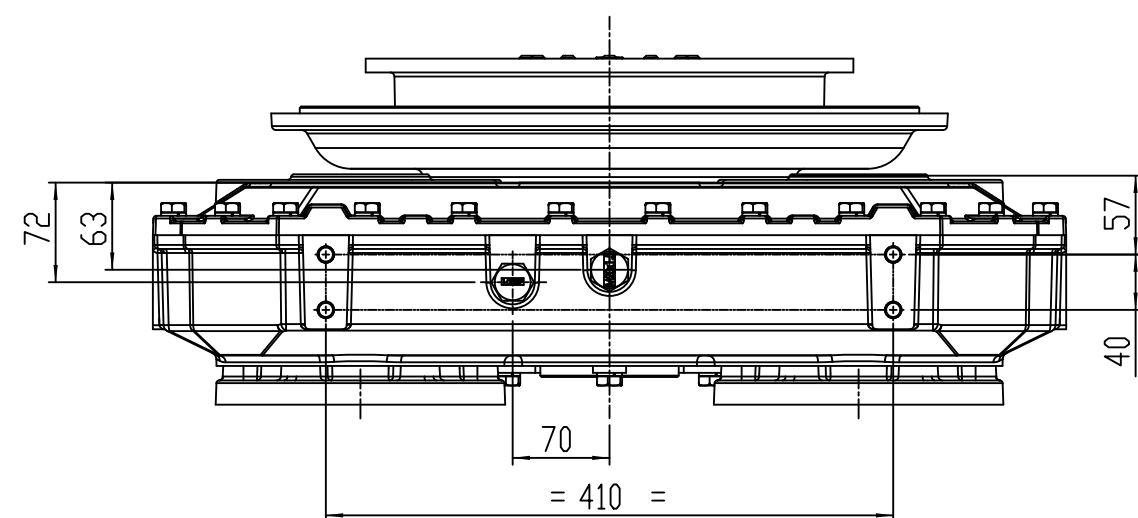
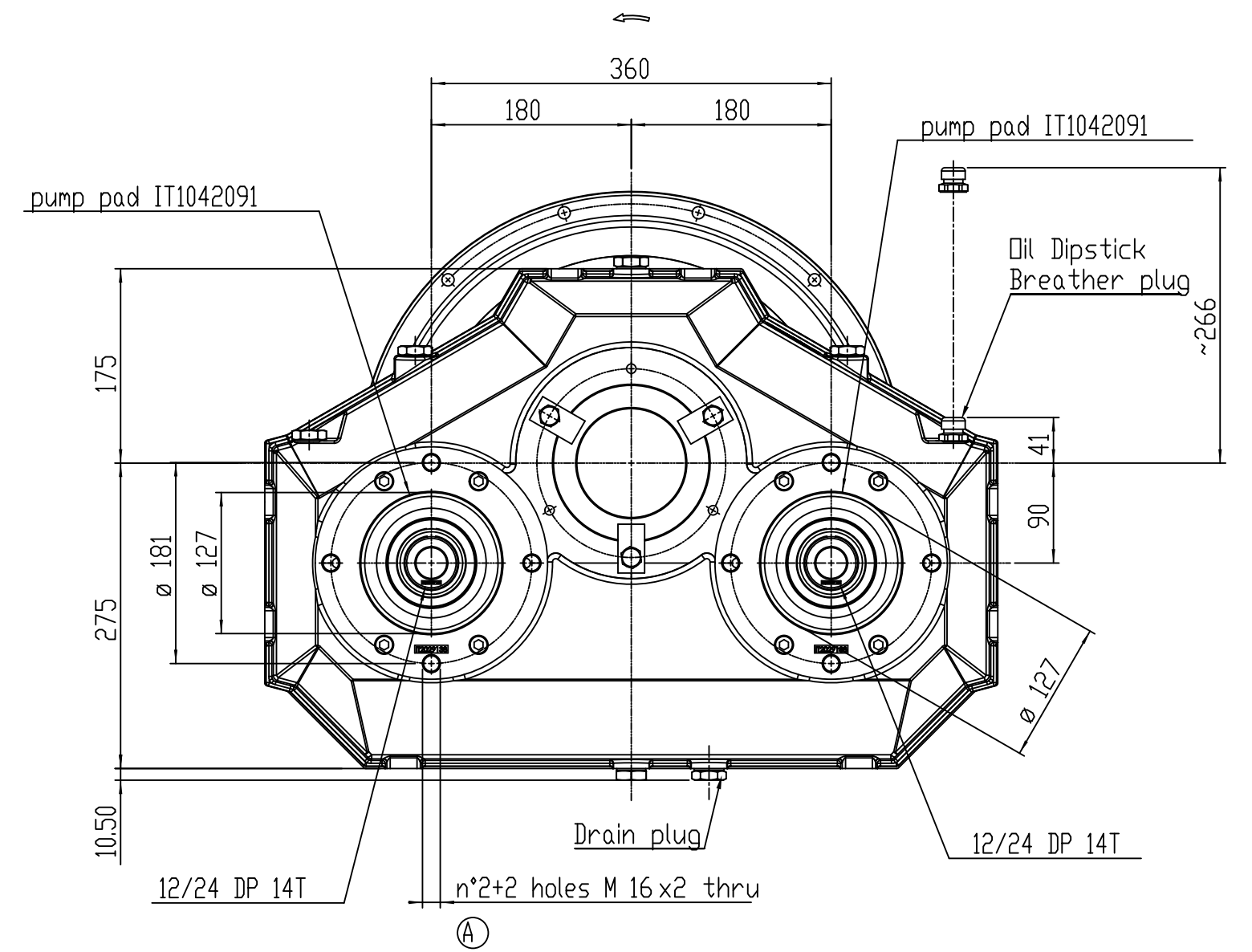
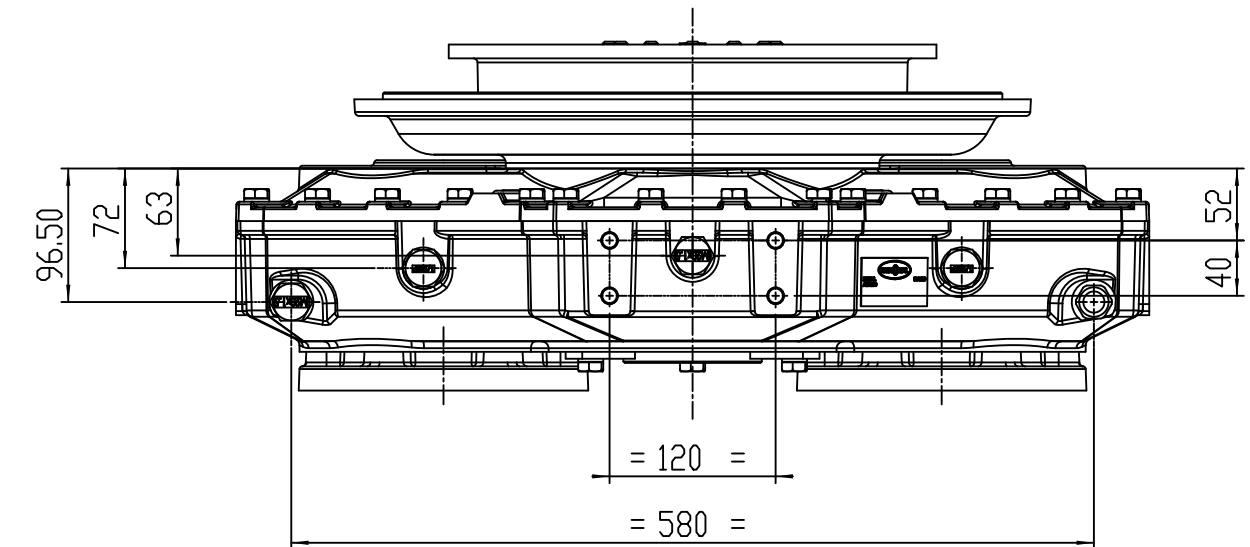
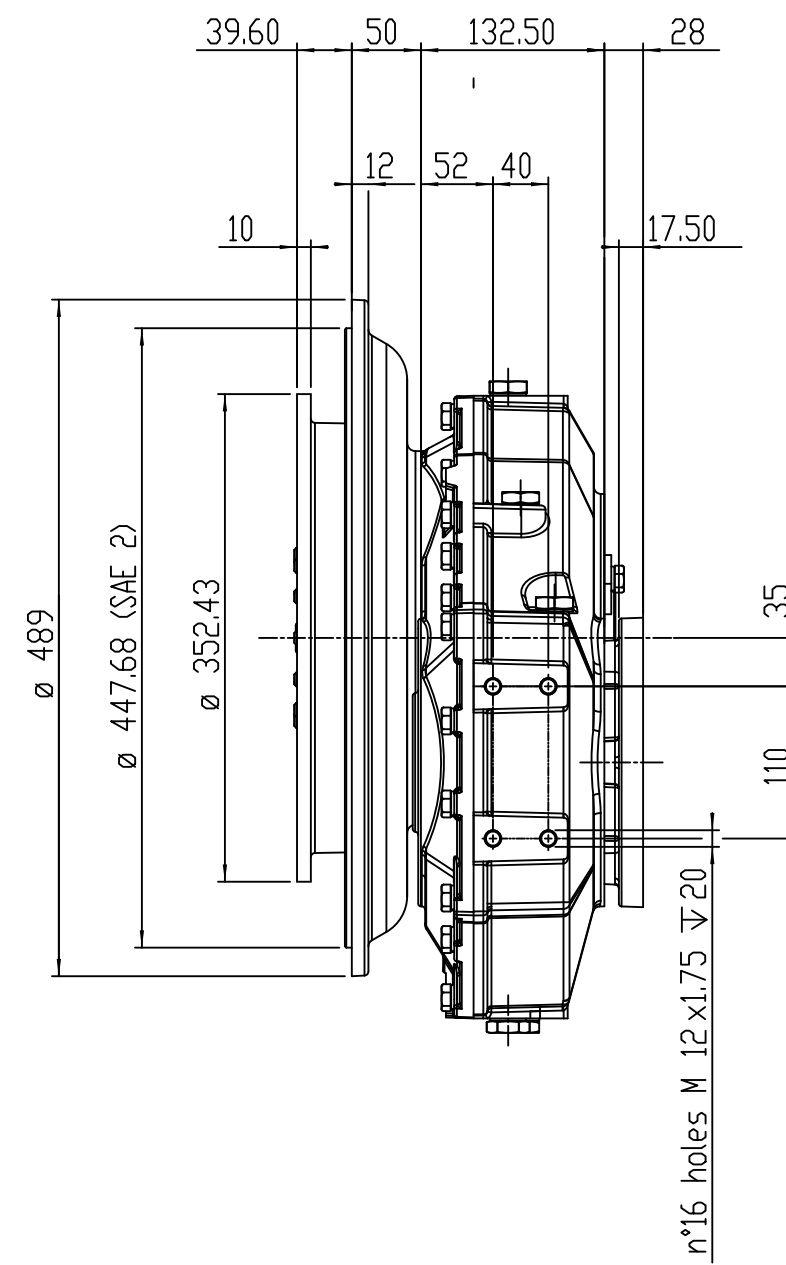
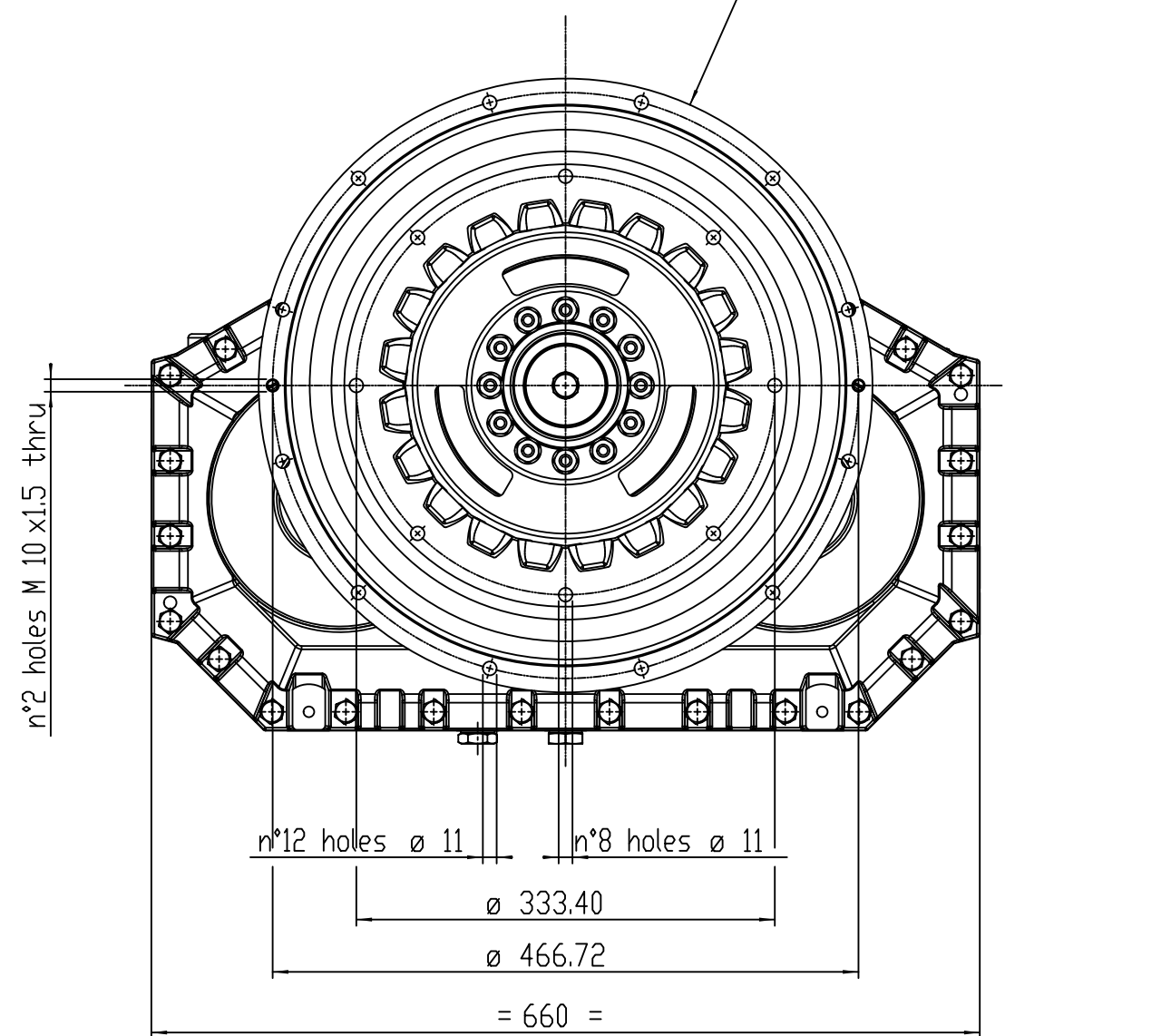

Drawing and 3D model are valid for all ratios

FIRST USE ASSEMBLY:	WEIGHT:	THIRD ANGLE PROJECTION	MATERIAL:	DATE:	TWIN DISC SRL - ITALY
FIRST USE MODEL:	M · 2		HEAT TREAT:	16-Dec-14	
SIMILAR TID	kg-m <sup>3</sup>	UNLESS OTHERWISE SPECIFIED MACHINED DIMENSIONS	DESCRIPTION:	SCALE:	<b>1029017D</b>
		L ± 0.75 II ± 0.25 III ± 0.15 ALL ANGULAR TOLERANCES ±1° GEOMETRIC TOLERANCING PER ASME Y14.5M 1994	Installation pump drive, AM 230 BOM n°1029016E	1:5	
METRIC			APPROVED BY:	DWG SIZE:	SHEET 1 OF 1 REV: A
<small>METRIC: THIS PRINT CONTAINS PROPRIETARY INFORMATION AND IS NOT TO BE USED IN ANY MANNER BENEFICIAL TO THE INTEREST OF TWIN DISC, INCORPORATED.</small> <small>THIS METRIC IS NOT INTENDED TO nullify OR LIMIT RIGHTS GRANTED TO THE U.S. GOVERNMENT OR OTHERS BY CONTRACT.</small>			Guzzinati	A2	