

Spicer 1610 hub input flange IT2062307

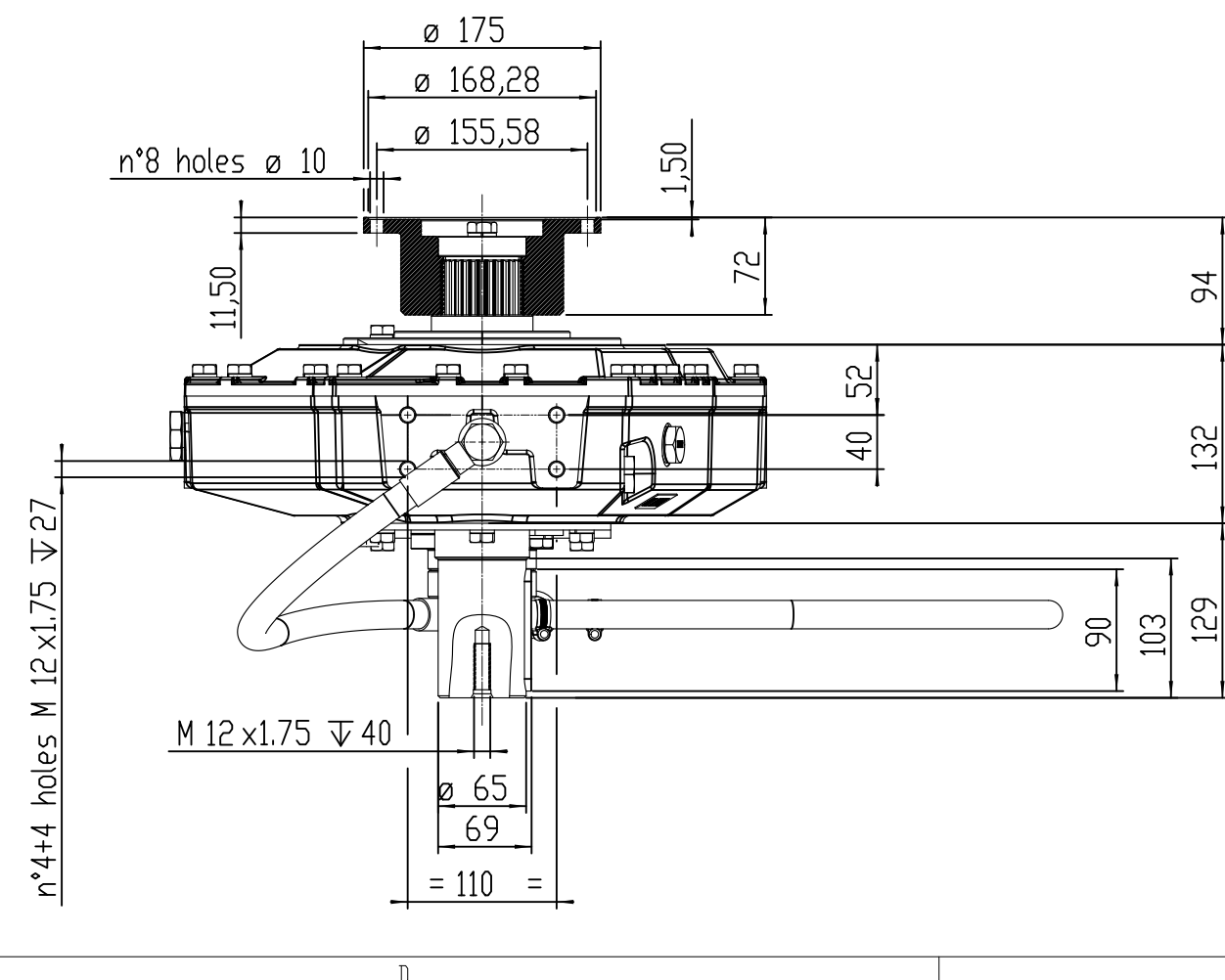

Special AM 232 rotated 90°: ITB90810007

Drawing and 3D model are valid for all ratios

FIRST USE ASSEMBLY: FIRST USE MODEL: SIMILAR TID		WEIGHT: kg kg-m ³	THIRD ANGLE PROJECTION	MATERIAL:	DATE: 19-Apr-16
METRIC		UNLESS OTHERWISE SPECIFIED MACHINED DIMENSIONS I ± 0,75 II ± 0,25 III ± 0,13	HEAT TREAT:	DESCRIPTION: Installation pump drive, AM 232 BDM n°1029018F	SCALE: 1:5
NOTICE: THIS PRINT CONTAINS PROPRIETARY INFORMATION AND IS NOT TO BE USED IN ANY MANNER BEYOND THAT OF THE INTEREST OF TWIN DISC, INCORPORATED. THIS NOTICE IS NOT INTENDED TO WAIVE OR LIMIT RIGHTS GRANTED TO THE U.S. GOVERNMENT OR OTHERS BY CONTRACT.		ALL ANGULAR TOLERANCES: 1° GEOMETRIC TOLERANCING PER ASME Y14.5M 1994	APPROVED BY: Guzzinati	REV: -	DATE: 11-04-16
TWIN DISC		SHEET: 1 OF 1		1029019D	
Format: A2-TAP-IT		REV: -		DATE: 11-04-16	