

DIN 120 input flange
IT2062137

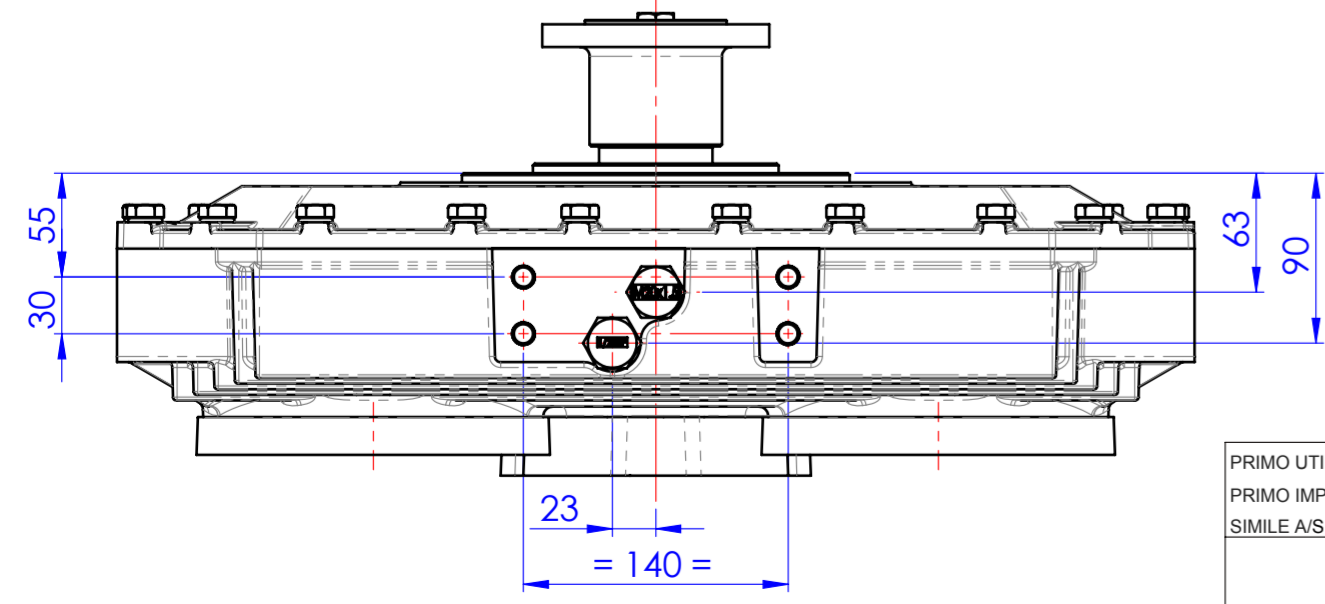
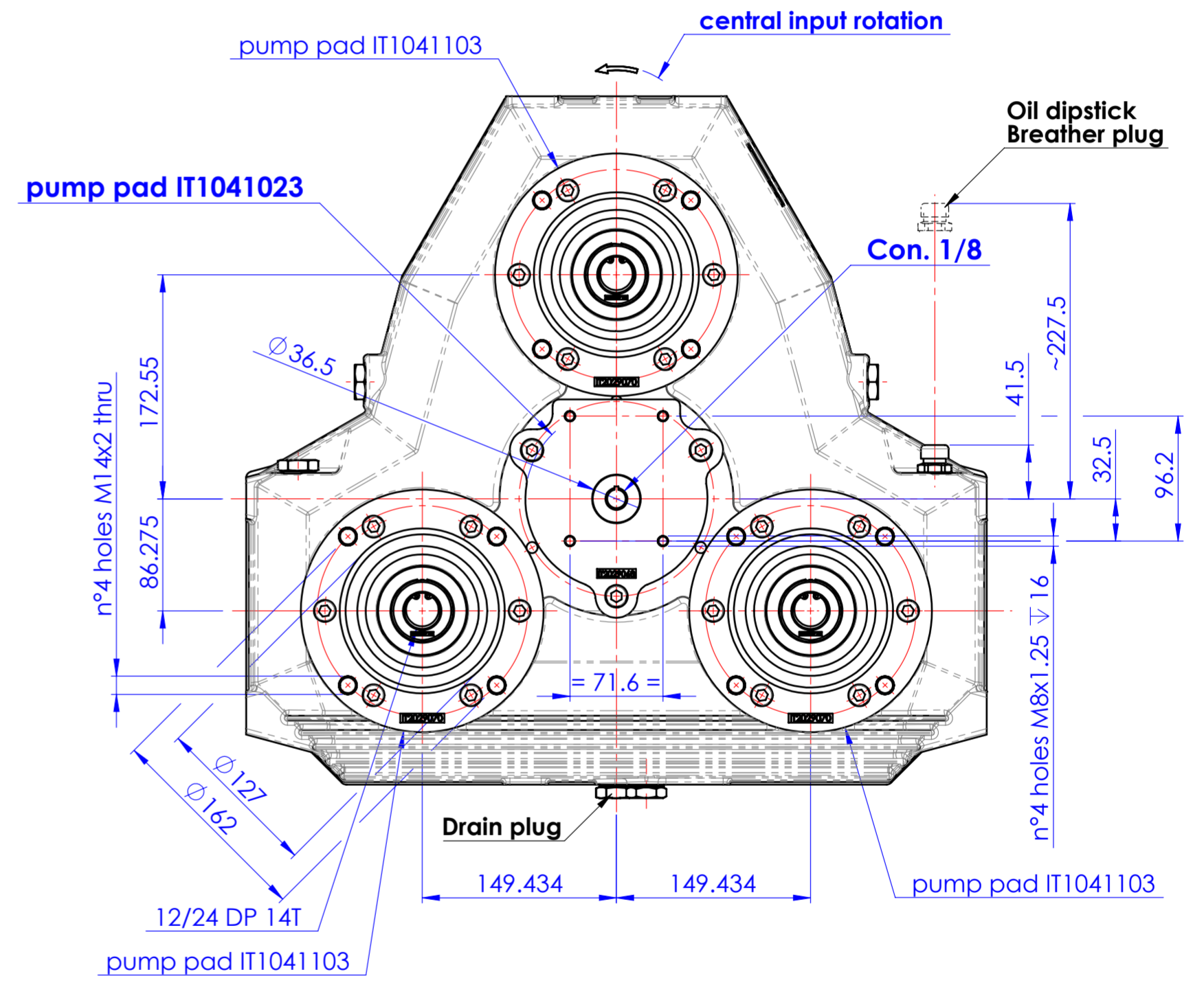
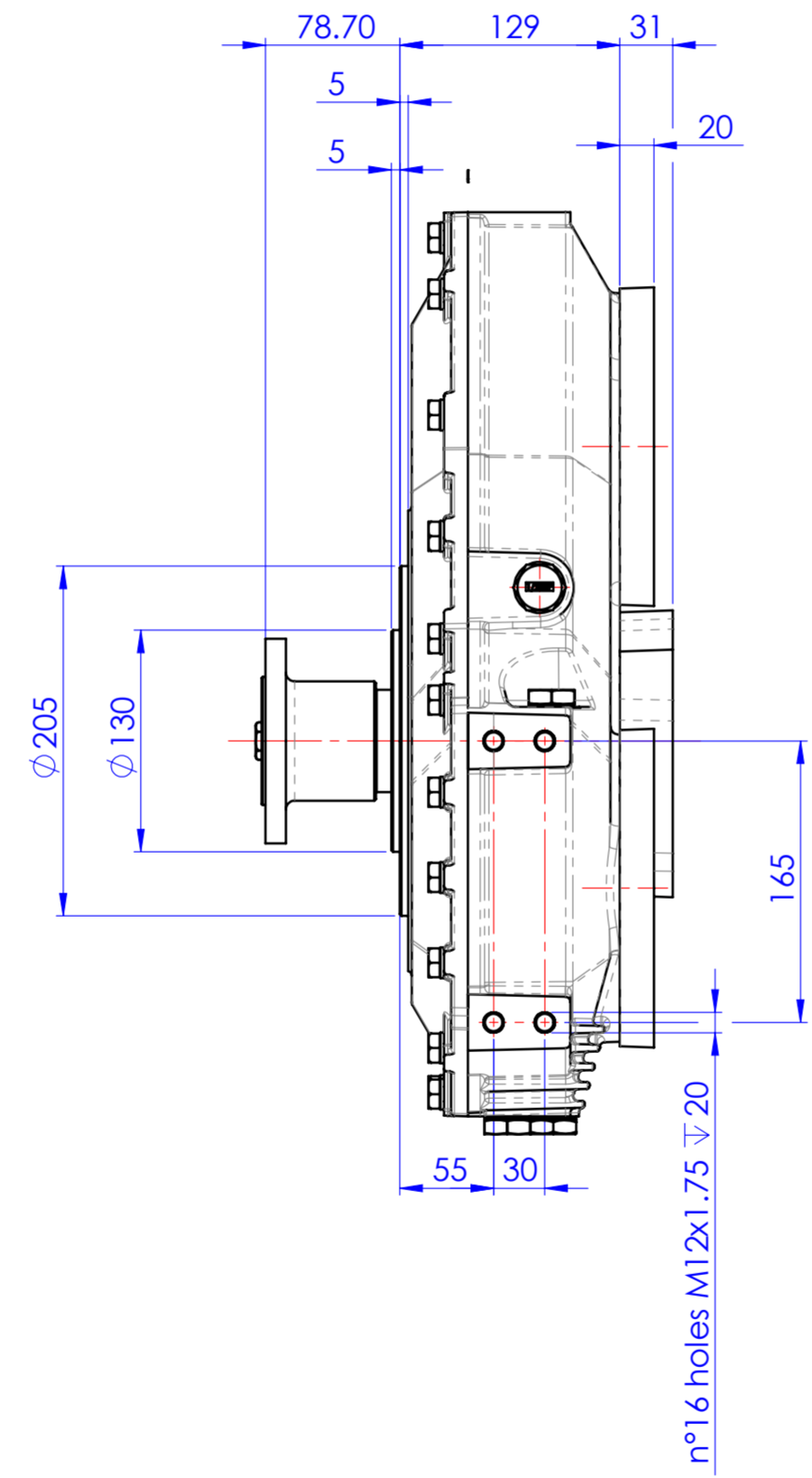
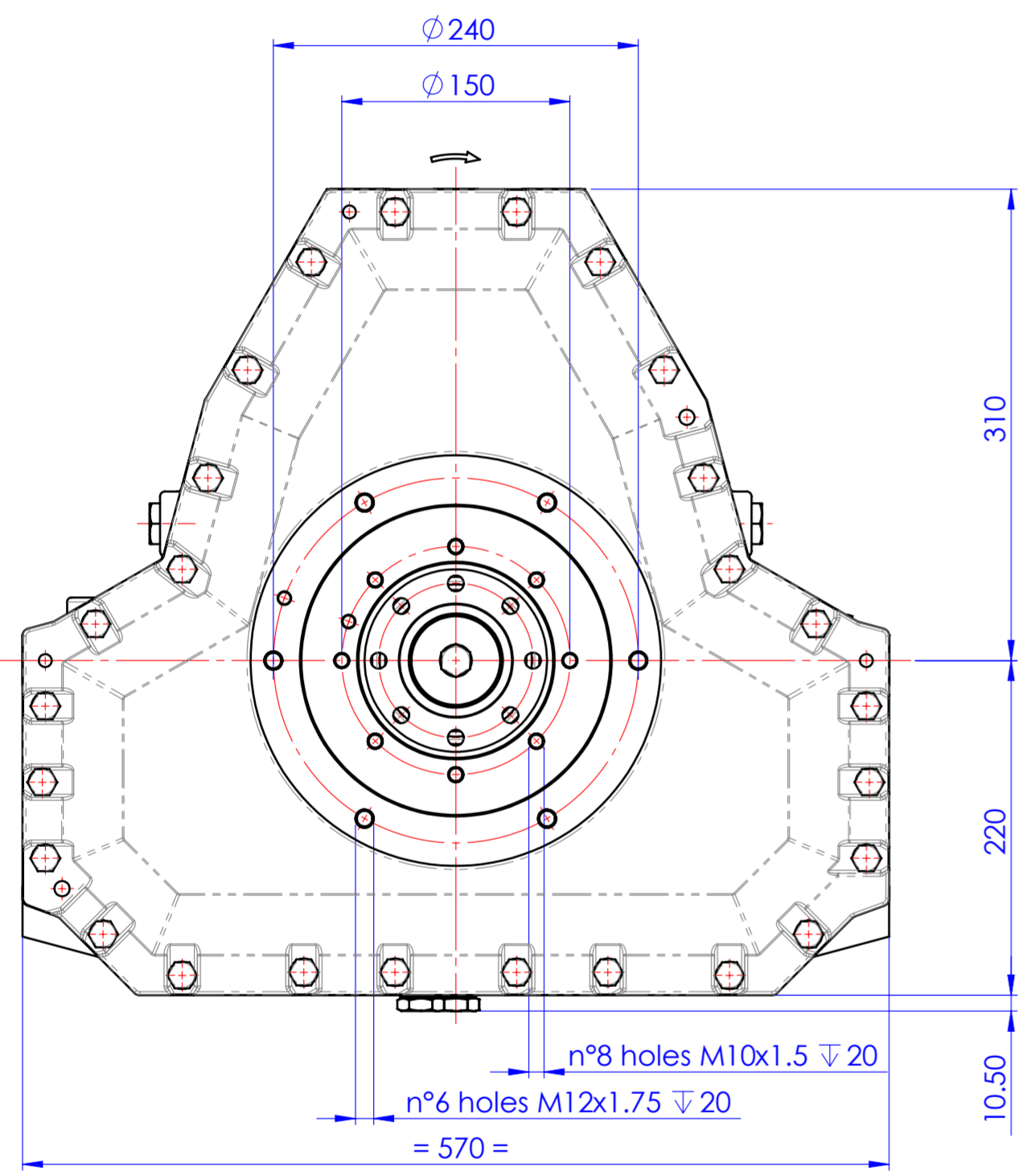
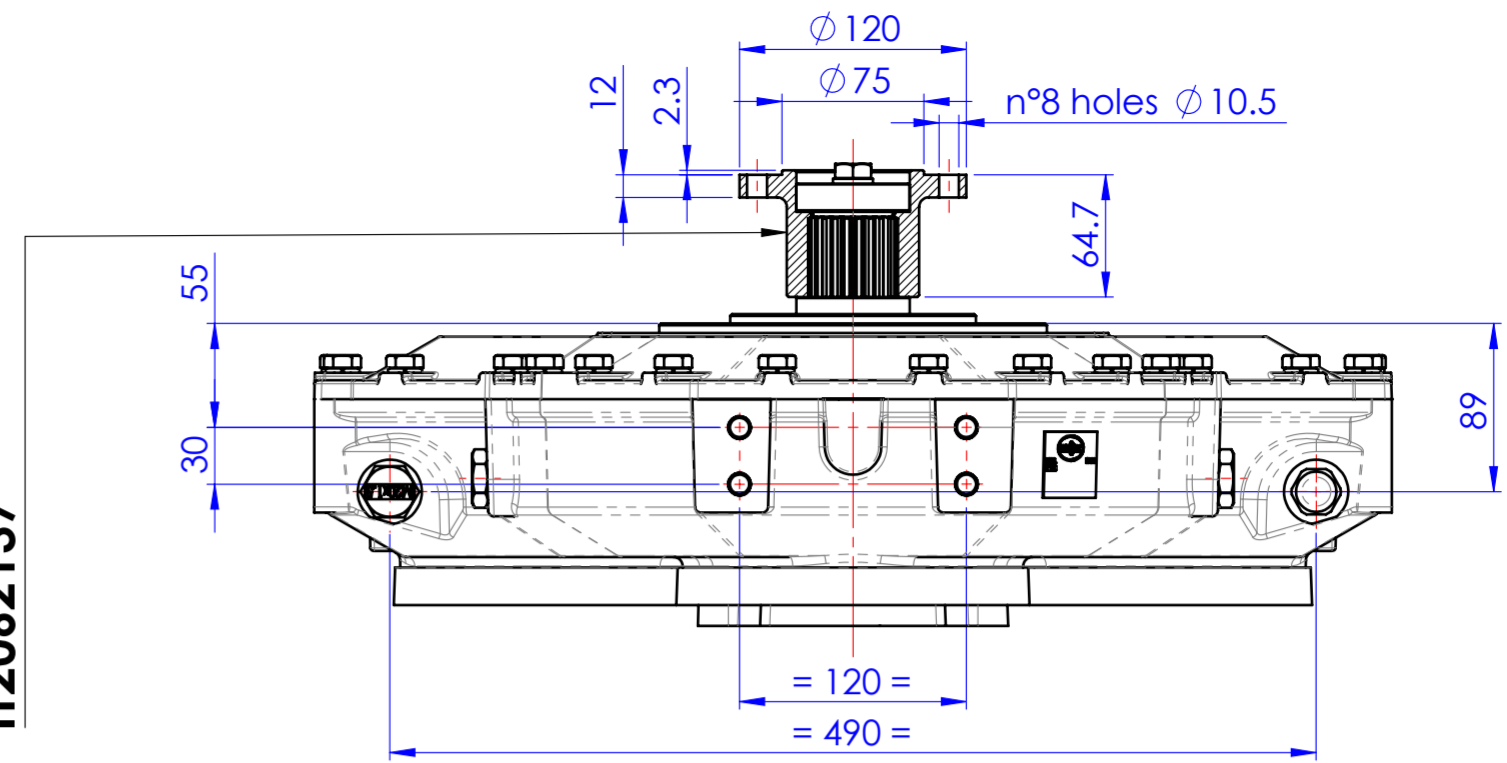

Drawing and 3D model are valid for all ratios

PRIMO UTILIZZO MONTAGGIO/FIRST USE ASSEMBLY: PRIMO IMPIEGO MODELLO/FIRST USE MODEL: SIMILE A/SIMILAR TO: METRIC		MODELLO / MADE FROM:	MATERIALE / MATERIAL:	DATA / DATE: 10/04/2016	INDIC. MODIF. / CHANGE NO.	MODIFICA / CHANGE NO.	DATA / DATE
NOTICE! THIS PRINT CONTAINS PROPRIETARY INFORMATION AND IS NOT TO BE USED IN ANY MANNER DETRIMENTAL TO THE INTEREST OF TWIN DISC, INCORPORATED. THIS NOTICE IS NOT INTENDED TO NULLIFY OR LIMIT RIGHTS GRANTED TO THE U.S. GOVERNMENT OR OTHERS BY CONTRACT.		PESO / WEIGHT: WR: kg kg-m ³	TRATT. TERMICO / HEAT TREAT:	DESCRIZIONE: INGOMBRO AM330 BOM 1029022J	DESCRIZIONE: INSTALLATION PUMP DRIVE AM330 BOM 1029022J	TRATT. SUP. / SURFACE TREATMENT:	INDIC. MODIF. / REV:
THIRD ANGLE PROJECTION		TITOL. GEN. DILAVORAZIONE H13 FORO - H13 ALBERO 1,14 DIMENSIONI LINEARI 15' fino 200 10' fino 500	DESCRIZIONE:	DESCRIZIONE:	DESCRIZIONE:	DESCRIZIONE:	INDIC. MODIF. / REV:
C		B		A		1	

NDWF-4000097 10/06/2016

TWIN DISC

DECIMA - ITALY

1029023E

1 OF 1