

TEST PORTS					
SYMBOL	DESCRIPTION	PORT/ STANDARD	DESCRIPTION	CLEARANCE FOR REMOVAL (mm)	ELECTRICAL CONNECTION
G	LUBE	M14 X 1.5 / ISO 9974	FLAT FACE PORT	12	-
Q <sub>L</sub>	LUBE FLOW FROM VALVE	M22 X 1.5 / ISO 6149	O-RING PORT	-	-
Q <sub>C</sub>	CLUTCH FLOW FROM VALVE	M22 X 1.5 / ISO 6149	O-RING PORT	-	-
Q <sub>S</sub>	FLOW FROM SUMP	1-1/16"-12 / UN	O-RING PORT	-	-
Q <sub>O</sub>	FLOW TO SUMP	SIZE 51 / ISO 6162 (CODE 61) M12 X 1.75 - Gr.10.9	FLANGE PORT	-	-
Q <sub>SC</sub>	FLOW BEFORE COOLER	7/8"-14 / UNF	O-RING PORT	-	-
S <sub>I</sub>	INPUT SPEED SENSOR (77 PULSES PER REV.)	5/8"-18 / UNF	FLAT FACE PORT	-	DEUTCH DT04-3P
S <sub>O</sub>	OUTPUT SPEED SENSOR (65 PULSES PER REV.)	5/8"-18 / UNF	FLAT FACE PORT	-	DEUTCH DT04-3P

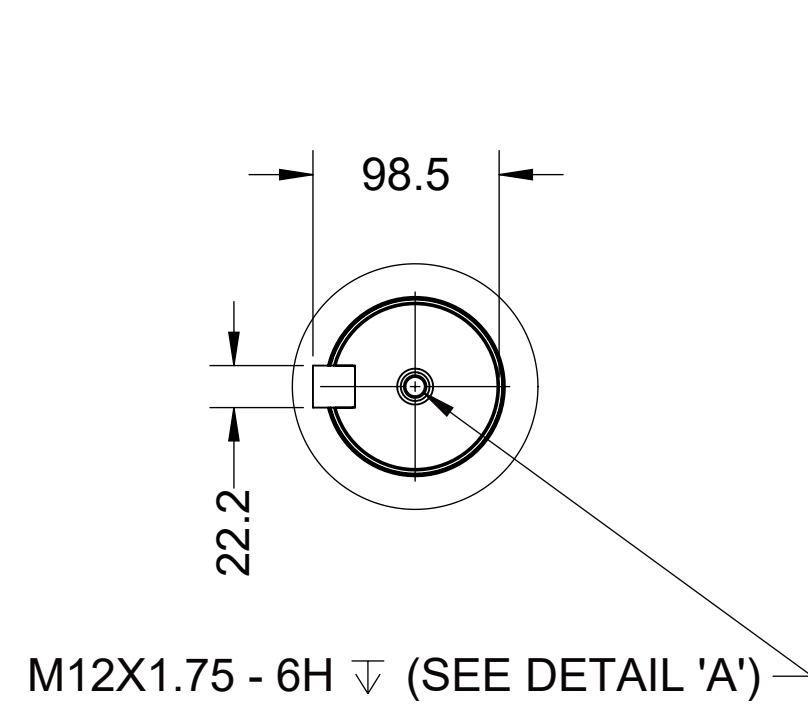
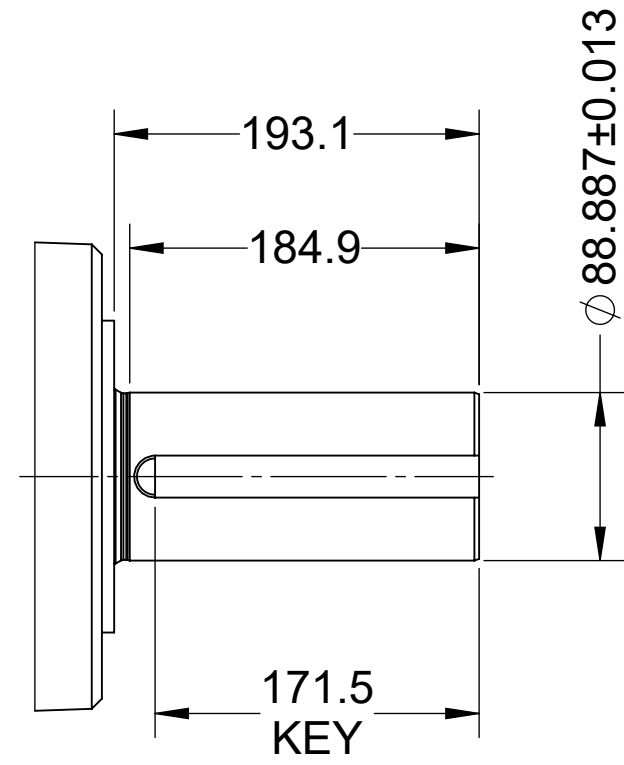

FIRST USE ASSEMBLY: S1041027 FIRST USE MODEL: HP500N SIMILAR TO:	WEIGHT: 382.0g WR: kg-m	THIRD ANGLE PROJECTION	MATERIAL:	DATE: 12/7/2017 SCALE: 1:4 DRAWN BY: JMB CHECKED BY: JEL APPROVED BY: GAM	HEAT TREAT:	DESCRIPTION: INSTALLATION HPTO, HP500	DWG SIZE: A1 SHEET: 1 OF 1 REV: B	ECNWF-101911 06/29/2021 CHANGE NO. DATE	TWIN DISC RACINE, WI 53403 - USA 1029980B
--	----------------------------	------------------------	-----------	---	-------------	---------------------------------------	---	--	---

NOTES: THIS PRINT CONTAINS PROPRIETARY INFORMATION AND IS NOT TO BE USED IN ANY MANNER DETRIMENTAL TO THE INTEREST OF TWIN DISC, INCORPORATED. THIS NOTICE IS NOT INTENDED TO NULLIFY OR LIMIT RIGHTS GRANTED TO THE U.S. GOVERNMENT OR OTHERS BY CONTRACT.

UNLESS OTHERWISE SPECIFIED  
MACHINED DIMENSIONS  
X .005  
X .002  
X .001  
ALL ANGULAR TOLERANCES ±1°  
GEOMETRIC TOLERANCING PER ASME Y14.5M 1994