

## MGE-5065SC

### HYBRID-READY MARINE TRANSMISSION

Twin Disc has taken its field-proven marine transmissions and created the MGE Series of gearboxes. This design provides power from the motor immediately in both clockwise and counter-clockwise directions. All units are equipped with a bi-directional oil pump to provide lubrication no matter the direction of shaft rotation, making these units a perfect fit for serial hybrid and diesel-electric applications or any application requiring a direct power response with a ratio reduction.

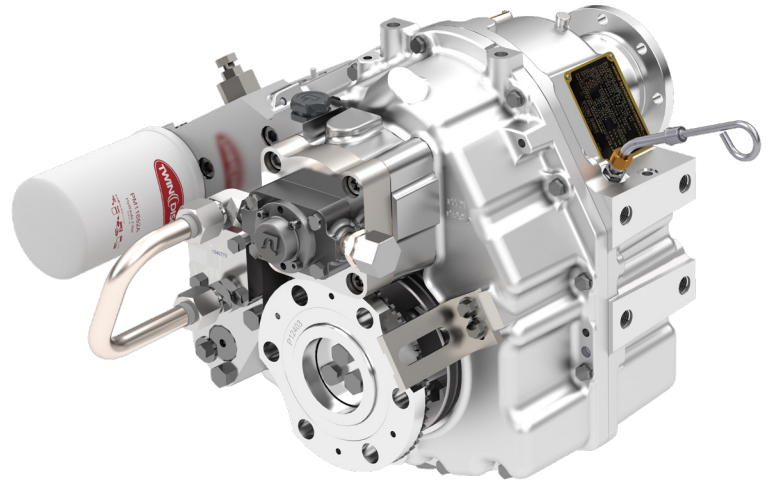

### FEATURES & BENEFITS

- Vertical offset, lightweight aluminum alloy housing
- Bi-directional lubrication pump
- Simplified design without a clutch
- Same installation envelope as standard marine transmission
- Same ratios as MGX-5065SC
- Metric design (except for some power transmitting and plumbing components)
- Marine survey society type approvals and unit certification available upon request

### STANDARD EQUIPMENT

- Input flange for freestanding installation
- Oil filter and oil strainer mounted

### INPUT RATINGS

Reduction Ratios :1	Pleasure Craft @2500 RPM	Light Duty @2300 RPM	Intermediate Duty @2100 RPM	Medium Duty @1800 RPM	Continuous Duty @1800 RPM
1.08, 1.26, 1.47 1.72, 2.04	425 kW (570 hp)	376 kW (504 hp)	279 kW (374 hp)	227 kW (304 hp)	216 kW (290 hp)
2.43	400 kW (536 hp)	351 kW (471 hp)	254 kW (341 hp)	208 kW (279 hp)	199 kW (267 hp)

For service classification definitions and important notes refer to the Twin Disc Marine Product Guide or contact Twin Disc directly.  
The maximum allowable rated engine/motor speed is 3600 rpm.

## OPTIONAL EQUIPMENT

- Companion flange/bolts set
- Mounted heat exchanger
- Mounting brackets
- Monitoring devices to customer's specification

## BASIC DIMENSIONS & WEIGHT

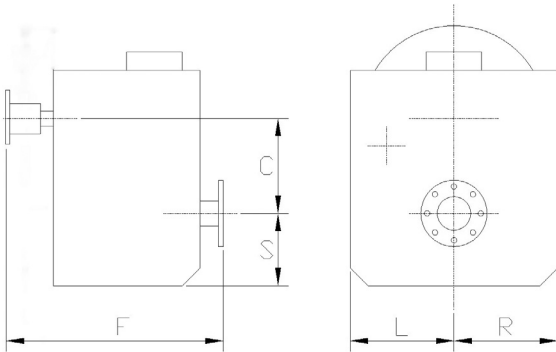

C	152 mm (6.00 in)
S	133 mm (5.22 in)
F	394 mm (15.51 in)
L	254 mm (10.00 in)
R	165 mm (6.50 in)
Weight*	87 kg

\* Estimated dry weight with GWB 587.20 input hub.

Since 1918, we've been putting horsepower to work by designing, engineering and manufacturing rugged-duty industrial products. Our products and our reputation are bolted to the most renowned engine manufacturers and equipment OEMs in the world. Our mission is to make boats, machines and off-highway vehicles more productive, more durable, more operator-friendly, and more cost-effective. From design and installation consultation through after-sale support, Twin Disc and its distributors are committed to your business. No one knows more about managing horsepower in more ways than Twin Disc.

TRANSMISSIONS

ELECTRONIC CONTROLS

EXPRESS JOYSTICK SYSTEM®

SAILDRIVES

EXPRESS POSITIONING®

ARNESON® SURFACE DRIVES

MARINE CONTROL DRIVES

ROLLA™ PROPELLERS

VETH PROPULSION SYSTEMS

STEERING SYSTEMS

PUMP DRIVES

PTOS

Specifications subject to change without prior notice in the interest of continual product improvement.  
Contact your local Twin Disc representative for engineering specifications, Survey Society Approvals and Classifications.

Twin Disc, Incorporated reminds users of these products that their safe operation depends on use in compliance with engineering information provided in our catalog. Users are also reminded that safe operation depends on proper installation, operation and routine maintenance and inspection under prevailing conditions. It is the responsibility of users (and not Twin Disc, Incorporated) to provide and install guards or safety devices which may be required by recognized safety standards or by the Occupational Safety and Health Act of 1970 and its subsequent provisions.