

NOTE:
 TO INSURE NO PRELOAD ON SHIFTING
 MECHANISM, HAND LEVER POSITION SHOULD
 BE SLIGHTLY PAST VERTICAL POSITION OR
 TOWARDS ENGINE.

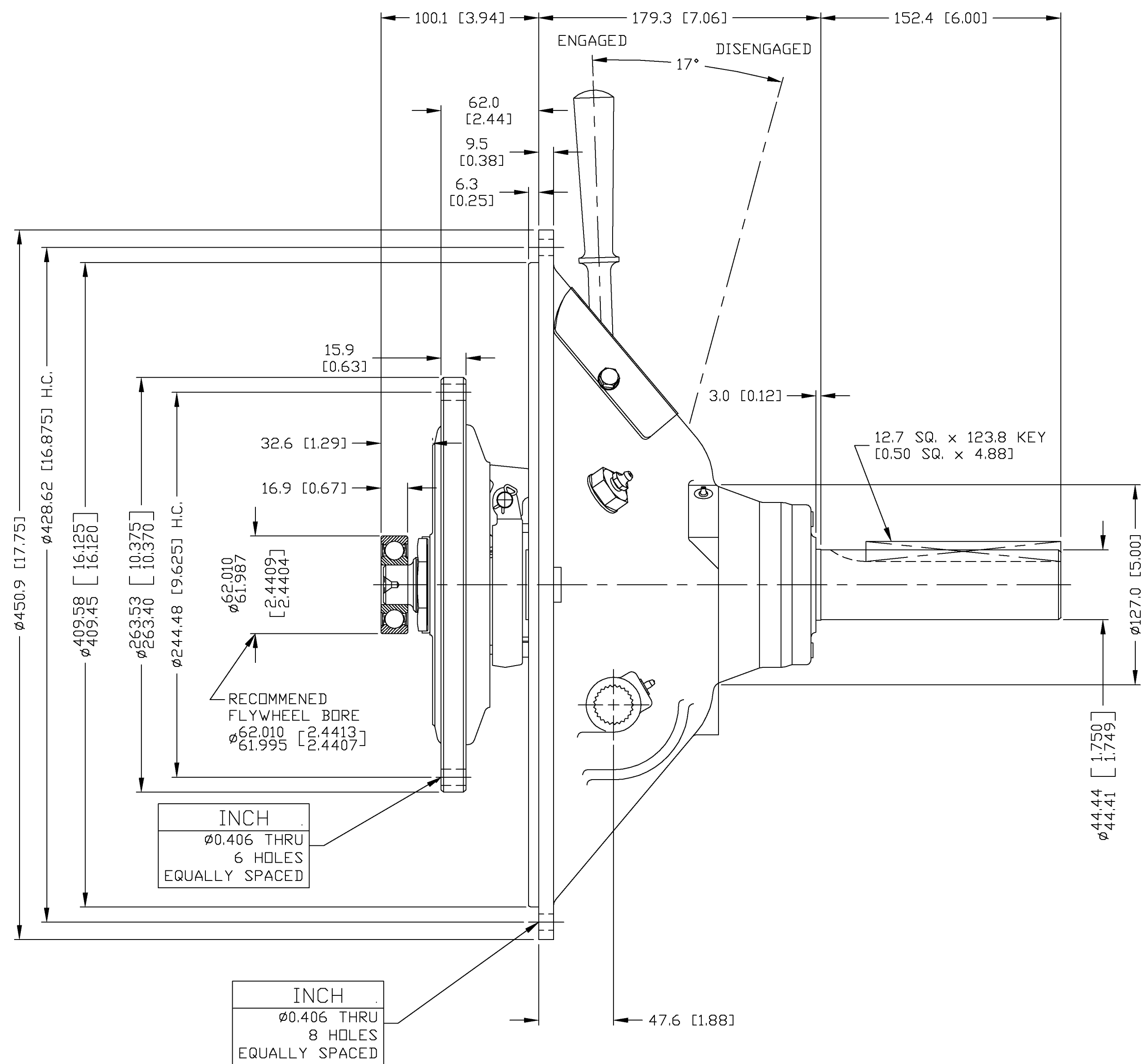

INCH
 3/8-16 UNC THRU
 2 HOLES, 180° APART

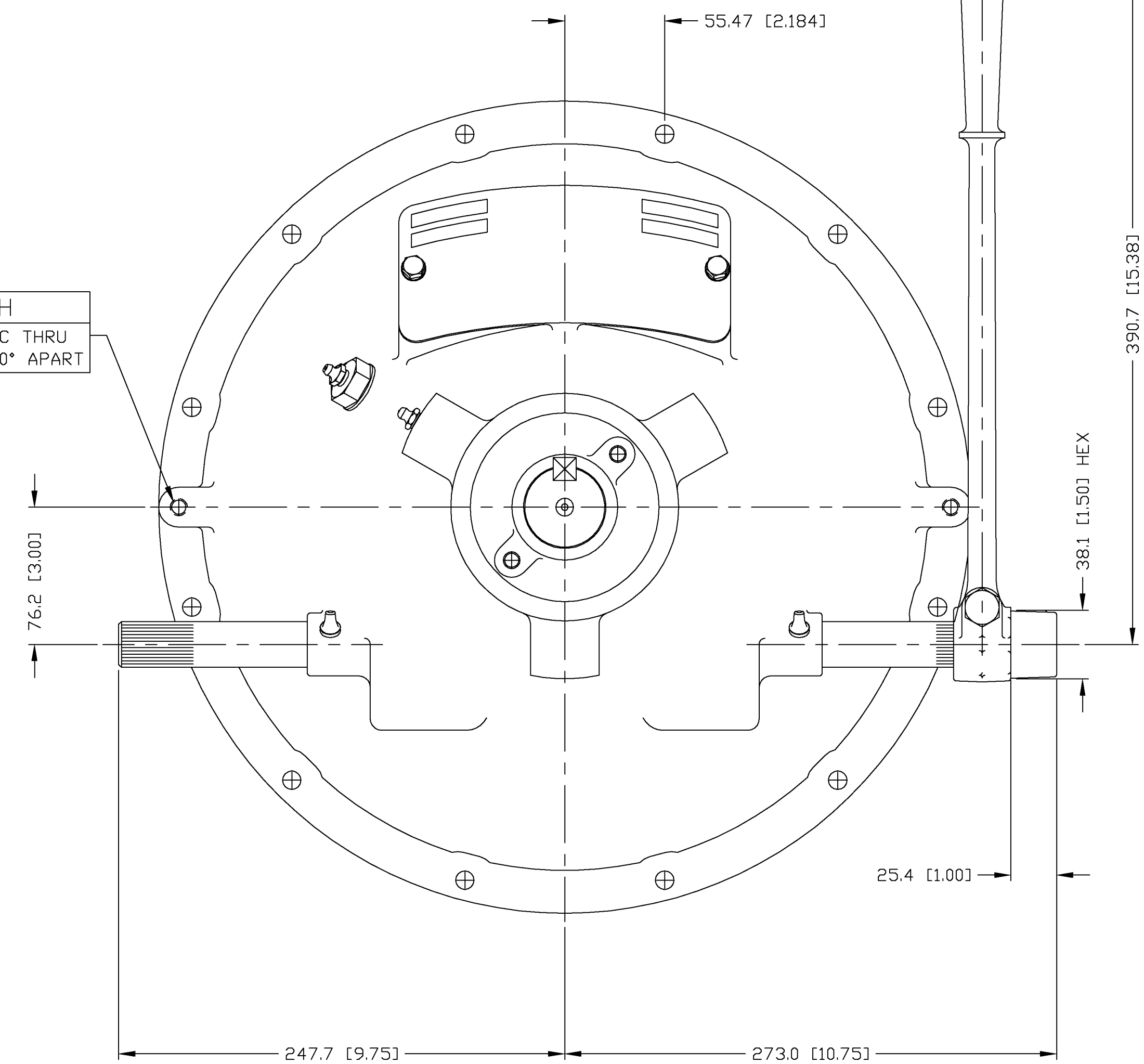

GENERAL NOTES:
 a.) REFER TO BILL OF MATERIAL WHEN ORDERING PARTS.
 b.) REFER TO CARE & OPERATION MANUAL FOR ADDITIONAL INFO.

UNLESS OTHERWISE SPECIFIED DIMENSIONS ARE IN MILLIMETERS MACHINED DIMENSIONS X .075 XX .025 XXX .013 ALL ANGULAR TOLERANCES ±1° GEOMETRIC TOLERANCING PER ASME Y14.5M 1994	WEIGHT kg	WRP N.A.	FIRST USE ASSY. CX108P301 MODEL C108HP5	METRIC THIRD ANGLE PROJECTION	MATERIAL	HEAT TREAT	DATE 01-29-96	TWIN DISC INCORPORATED RACINE, WI 53403 - USA	
	NOTICE: THIS PRINT CONTAINS PROPRIETARY INFORMATION AND IS NOT TO BE USED IN ANY MANNER DETRIMENTAL TO THE INTEREST OF TWIN DISC, INCORPORATE THIS NOTICE IS NOT INTENDED TO WAIVE OR LIMIT RIGHTS GRANTED TO THE U.S. GOVERNMENT OR OTHERS BY CONTRACT.					SIMILAR TO	NAME C108HP3 POWER TAKEOFF		SCALE 1:50 = 1
							DWG SIZE A1	SHT 2 OF 2	REV B