

MGX-5114SC-HD/MGX-5114DC

**MAXIMUM 673 KW (900 HP)
@ 2300 RPM (PLEASURE CRAFT)**



QUICKSHIFT®
BY TWIN DISC

STANDARD EQUIPMENT

- Vertical offset, cast iron housing
- SAE J617 housing no. 1
- Electric GP-valve with manual override
- EC600PC profile module – interface for engagement signals
- Oil strainer and oil filter

INPUT RATINGS

	Reduction Ratios :1	Pleasure Craft @ 2300 RPM	Light Duty @ 2300 RPM	Intermediate Duty @ 2100 RPM	Medium Duty @ 1800 RPM	Continuous Duty @ 1800 RPM
MGX-5114SC-HD	1.02, 1.12 1.50, 1.74, 2.04	673 kW (900 hp)	629 kW (843 hp)	504 kW (676 hp)	394 kW (528 hp)	358 kW (480 hp)
	2.54			540 kW (724 hp)		
	3.00	400 kW (536 hp)	351 kW (471 hp)	451 kW (605 hp)	361 kW (484 hp)	328 kW (440 hp)
MGX-5114DC	3.28, 3.43 4.17	673 kW (900 hp)	629 kW (843 hp)	504 kW (676 hp)	361 kW (484 hp)	347 kW (465 hp)
	4.59	634 kW (850 hp)	591 kW (793 hp)	448 kW (601 hp)		
	4.86	604 kW (810 hp)	565 kW (758 hp)	429 kW (575 hp)		

For service classification definitions and important notes refer to the Twin Disc Marine Product Guide or contact Twin Disc directly.
Ratings shown for use with standard right hand rotation engines. The maximum allowable rated engine speed is 3000 rpm.

EC600PC ELECTRONIC PROPULSION CONTROL SYSTEM

- Optional equipment: display and joystick



OPTIONAL EQUIPMENT

- Flexible coupling for 14" flywheel (SAE J620 size 355)
- Input flange size GWB 587.35 for freestanding installation
- Mechanical control valve
- EC600PC e-troll module and propulsion control system
- Oil cooler with thermostatic bypass valve
- Companion flange/bolts set
- Monitoring devices to customer's specification
- Mounting brackets
- Live PTO
 - SAE J744 size 82-2, 16-4 (SAE "A", 2-bolt) – max. 58 Nm
 - SAE J744 size 101-2, 22-4 (SAE "B", 2-bolt) – max. 209 Nm
 - SAE J744 size 101-2, 25-4 (SAE "B-B", 2-bolt) – max. 338 Nm
 - SAE J744 size 127-4, 32-4 (SAE "C", 4-bolt) – max. 593 Nm
- Hydraulic clutchable PTO
 - SAE J744 size 127-4, 32-4 (SAE "C", 4-bolt) – max. 600 Nm
- Dry weight including SAE no. 1 housing and SAE 355 flexible coupling
 - MGX-5114SC-HD: 286 kg
 - MGX-5114DC: 394 kg

MGX-5114SC-HD

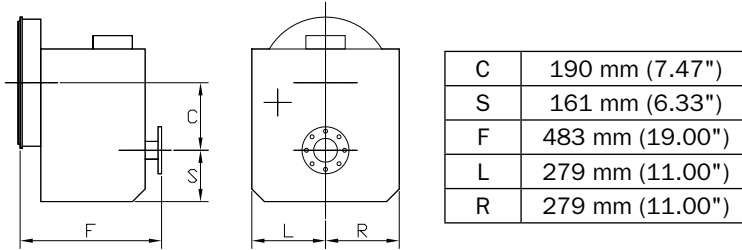

MGX-5114DC

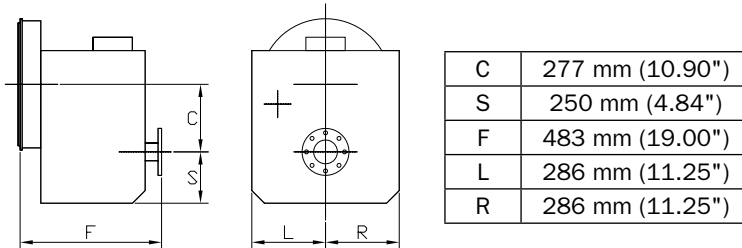

Since 1918, we've been putting horsepower to work by designing, engineering and manufacturing rugged-duty industrial products. Our products and our reputation are bolted to the most renowned engine manufacturers and equipment OEMs in the world. Our mission is to make boats, machines and off-highway vehicles more productive, more durable, more operator-friendly, and more cost-effective. From design and installation consultation through after-sale support, Twin Disc and its distributors are committed to your business. No one knows more about managing horsepower in more ways than Twin Disc.

TRANSMISSIONS

ELECTRONIC CONTROLS

EXPRESS JOYSTICK SYSTEM®

SAILDRIVES

EXPRESS POSITIONING®

ARNESON® SURFACE DRIVES

MARINE CONTROL DRIVES

ROLLA™ PROPELLERS

THRUSTERS

VETH PROPULSION SYSTEMS

STEERING SYSTEMS

RUDDERS

TRIM TABS

PUMP DRIVES

PTOS

Twin Disc, Incorporated reminds users of these products that their safe operation depends on use in compliance with engineering information provided in our product guides, installation/assembly drawings and/or manuals. Users are also reminded that safe operation depends on proper installation, operation and routine maintenance and inspection under prevailing conditions. It is the responsibility of users (and not Twin Disc, Incorporated) to provide and install guards or safety devices which may be required by recognized safety standards or by the Occupational Safety and Health Act of 1970 and its subsequent provisions.

USA • AUSTRALIA • BELGIUM • CHINA • INDIA • ITALY • NETHERLANDS • SINGAPORE • SWITZERLAND



Twin Disc, Incorporated
 Racine, Wisconsin 53403 USA
 Phone +1-262-638-4000
 Fax +1-262-638-4482
www.twindisc.com

2102_Bulletin_MGX-5114SC-HD/DC
 © 2021, Twin Disc, Incorporated
 Printed in the USA