

Maximum 1678 kW (2250 hp) @1800 RPM (MEDIUM DUTY)

STANDARD EQUIPMENT**MGX-61000SC**

Vertical offset, aluminum housing

Electric GP-valve with manual override

EC050 Profile module

– interface for engagement signals

Mounted oil cooler for raw water cooling

Oil strainer and oil filter

**INPUT RATINGS - KILOWATTS (KW) (HORSEPOWER (HP))***

For service classification definitions and important notes refer to www.twindisc.com, the Twin Disc Marine Product Guide or contact Twin Disc directly. Please contact Twin Disc for special rating approvals.

Reduction Ratios :1	Medium Duty		
	@ 1200 RPM	@ 1600 RPM	@ 1800 RPM
2.22, 2.54, 2.63 2.72, 3.03, 3.39	1119 kW (1500 hp)	1491 kW (2000 hp)	1678 kW (2250 hp)

* Ratings shown for use with standard right-hand rotation engines.
The maximum allowable rated engine speed is 2100 rpm.



Specifications subject to change without prior notice in the interest of continual product improvement.
Contact your local Twin Disc representative for engineering specifications, Survey Society Approvals and Classifications.

Scan QR code to see Twin Disc's entire Marine product line.



OPTIONS

- SAE J617 housing no.00
- Flexible coupling for 21" flywheel (SAE J620 size 530)
- Input hub for freestanding installation
- EC050 E-Troll module – interface for engagement & trolling signals
- Harness with single point interface to Twin Disc EC300 control system
- Oil cooler for fresh water cooling
- Output shaft driven trailing pump
- Companion flange/ bolts set
- Monitoring devices to customer’s specification
- Mounting brackets
- Live PTO
 - SAE J744 size 127-2/4, 32-4 (SAE “C”, 2/4-bolt) – max. 592 Nm
 - SAE J744 size 127-2/4, 38-4 (SAE “C-C”, 2/4-bolt) – max. 1187 Nm
- Hydraulic clutchable pump mount PTO
 - SAE J744 size 127-2/4, 32-4 (SAE “C”, 2/4-bolt) – max. 592 Nm
 - SAE J744 size 127-2/4, 38-4 (SAE “C-C”, 2/4-bolt) – max. 1186 Nm
- Dry weight incl. SAE #00 housing and SAE 530 flexible coupling: **1780 kg**

MGX-61000SC

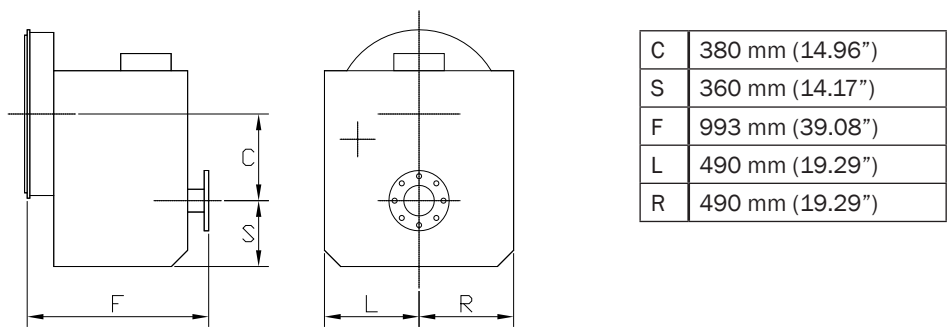

Twin Disc, Incorporated reminds users of these products that their safe operation depends on use in compliance with engineering information provided in our catalog. Users are also reminded that safe operation depends on proper installation, operation and routine maintenance and inspection under prevailing conditions. It is the responsibility of users (and not Twin Disc, Incorporated) to provide and install guards or safety devices which may be required by recognized safety standards or by the Occupational Safety and Health Act of 1970 and its subsequent provisions.

United States of America • Australia • Belgium • Canada • China • India • Italy • Singapore • Switzerland

For nearly a century, we’ve been making boats perform better and more reliably. From system-design consultation to application development to in-service support, Twin Disc provides fully integrated propulsion solutions that will optimize your craft’s performance, reliability and safety over the years. Bring Twin Disc aboard early in the development process, and you’ll enjoy a lifetime of enhanced operating value.

TRANSMISSIONS • ELECTRONIC CONTROLS • EXPRESS JOYSTICK SYSTEM® • SAILDRIVES • EXPRESS POSITIONING® • ARNESON SURFACE DRIVES • MARINE CONTROL DRIVES • ROLLA PROPELLERS • BOW & STERN THRUSTERS • STEERING SYSTEMS • RUDDERS • TRIM TABS



Twin Disc, Incorporated
Racine, Wisconsin 53403 USA
Phone +1-262-638-4000
Fax +1-262-638-4482
www.twindisc.com

*TD-Bulletin-MGX-61000SC
© 2016, Twin Disc, Incorporated
Printed in the USA - 2/2016*