

- | | |
|---|---------------------------------------|
| 1 | ENGINE FLYWHEEL HOUSING MOUNTING FACE |
| 2 | PTO GROUP MOUNTING FACE |
| 3 | LEFT BRACKET MOUNTING FACE |
| 4 | RIGHT BRACKET MOUNTING FACE |
| 5 | PUMP MOUNTING FACE |

NOTES :

- A. PROPORTIONAL CONTROL VALVE OPERATION.**
 1. WARNING DO NOT CONNECT VALVE COIL DIRECTLY TO BATTERY POSITIVE TERMINAL OR BATTERY VOLTAGE.
 2. OPERATION TO BE PERFORMED WITH ONLY TWIN-DISC CONTROL SYSTEM MODULES.
- B. MANUAL DIRECTIONAL CONTROL VALVE OPERATION.**
 1. WITH MANUAL DIRECTIONAL CONTROL VALVE IN CENTERED POSITION, PUSH TO ENGAGE PRIMARY CLUTCH.
 2. WITH MANUAL DIRECTIONAL CONTROL VALVE IN CENTERED POSITION, PULL TO ENGAGE SECONDARY CLUTCH.
- C. MANUAL DIRECTIONAL CONTROL VALVE MODE SWITCH.**
 1. SWITCH IS NORMALLY CLOSED WHEN MANUAL DIRECTIONAL CONTROL VALVE IS IN THE CENTERED POSITION AND OPEN WHEN OPERATOR IS ACTUATED TO CENTERED POSITION.
 2. CURRENT = 20 AMPS MAX.
 3. FOR WIRING SCHEMATIC, REFER TO CENTERED POSITION DRAWING.
- D. REFERENCE S830 FOR TWIN DISC REQUIREMENTS FOR PRESSURE AND ALARM.**
- E. UNLESS OTHERWISE SPECIFIED, FASTENER TORQUE VALUES PER S574 STANDARD.**
- F. ALL POINTS AVAILABLE FOR TESTING ARE CODED**



Ø 14.0 ± 0.2 DRILL THRU.,
8 HOLES EQUALLY SPACED
USE GRADE 5 PROPERTY CLASS QUALITY
CAPSCREWS PER S.A.E. J429 AND
TORQUE PER S574 OR SERVICE

USE HARDENED FLAT STEEL
WASHERS, R30N 61 MIN.
UNDER SCREW HEADS

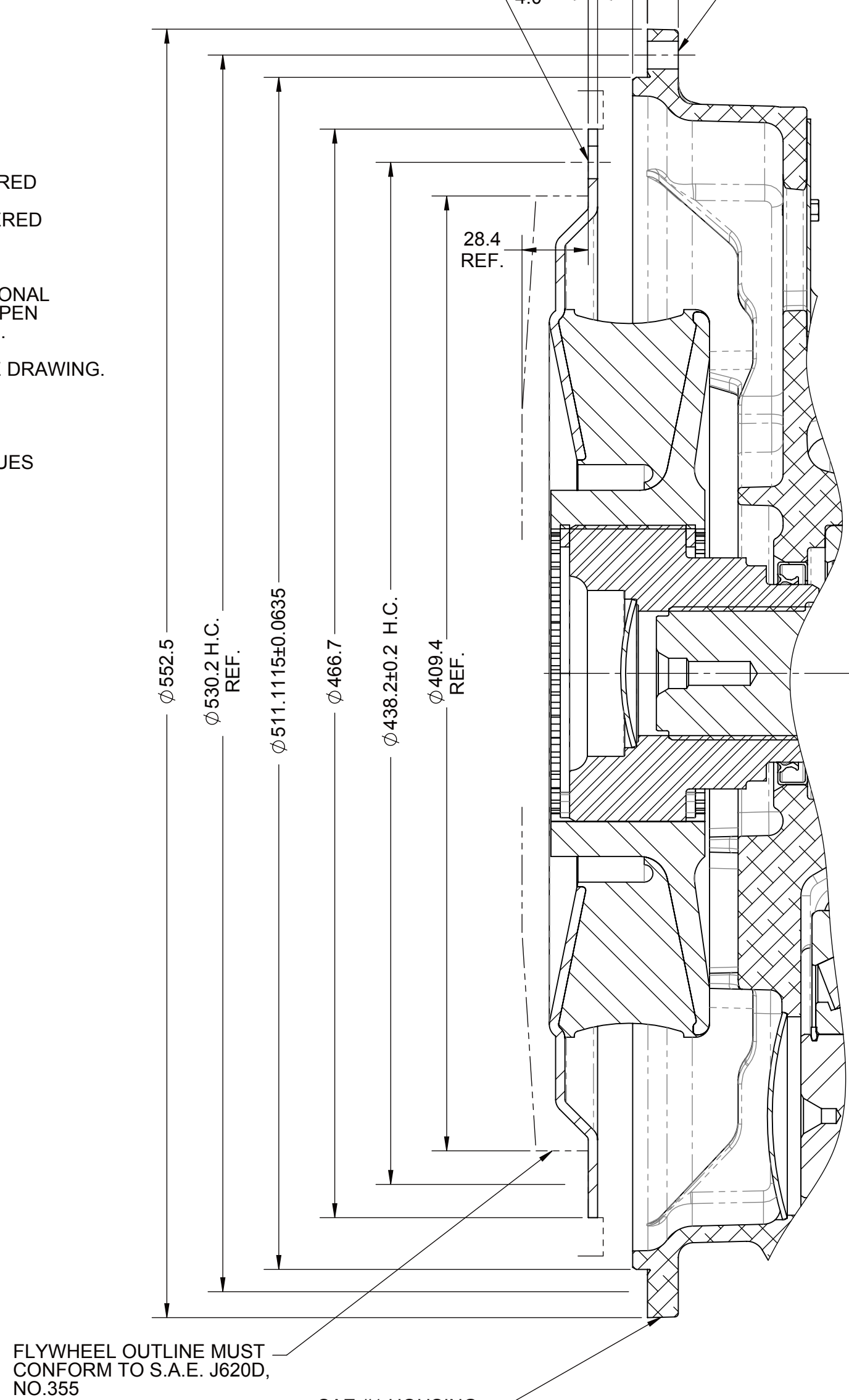

FLYWHEEL OUTLINE MUST
CONFORM TO S.A.E. J620D,
NO.355

SAE #1 HOUSING —
FACE MUST CONFORM
TO SAE J617

SECTION A-A

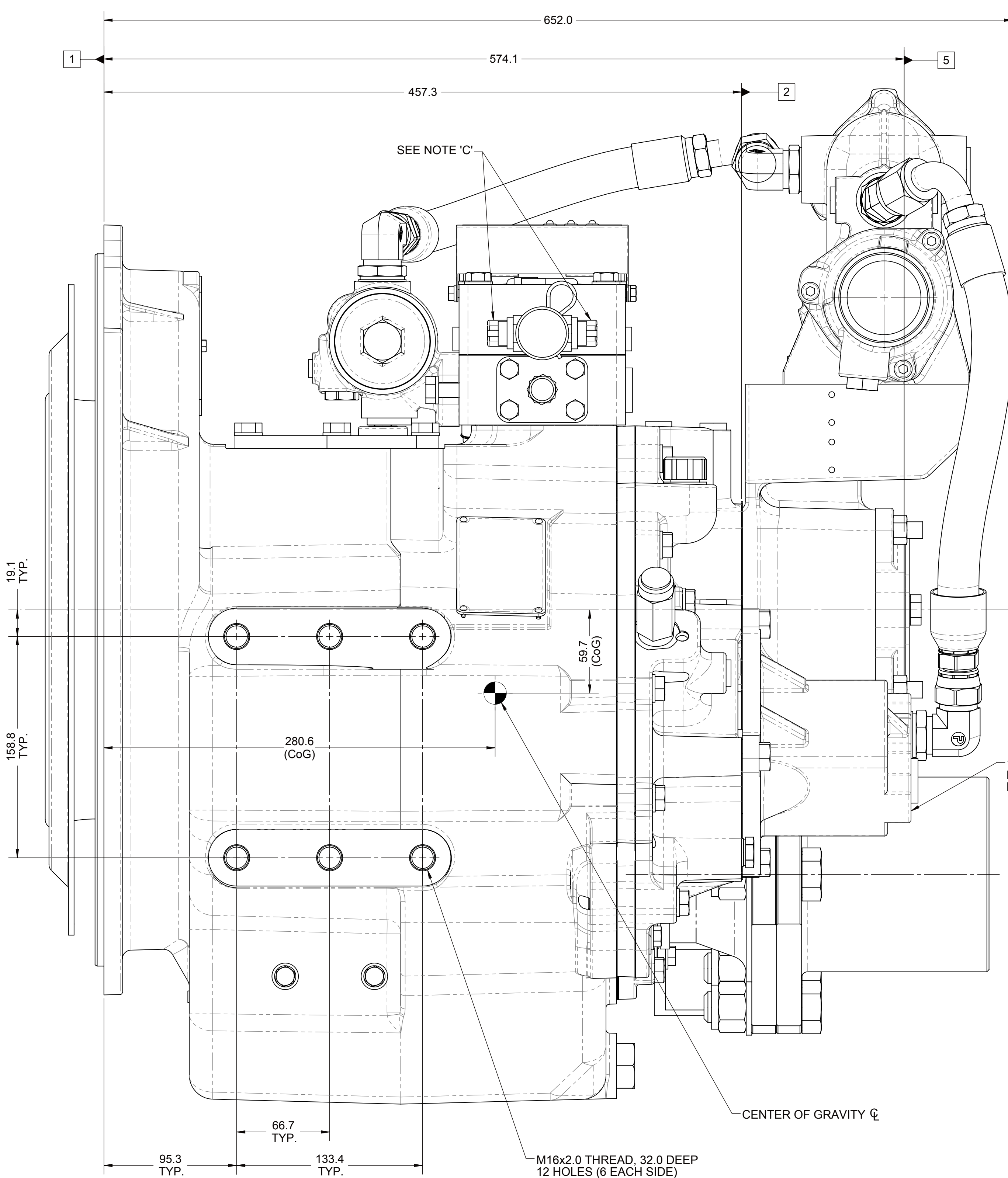

M16x2.0 THREAD, 32.0 DEEP
12 HOLES (6 EACH SIDE)
USE ALL (12) HOLES FOR MOUNTING
USE GRADE 5 QUALITY CAPSCREWS
PER S.A.E. J429 AND TORQUE TO
S574 OR SERVICE MANUAL VALUES.

EQUIPMENT SHOWN:

- EQUIPMENT SHOW:**
 -MGX-5114SC PER PX13160 ASSEMBLY
 -SAE #1/SAE 355 VULKAN VKE-4010 SERIES
 -GP VALVE WITH EC050 PROFILE MODULE
 -PM13008 MOUNTED HEAT EXCHANGER GROUP
 -LIVE PTO, SAE J744, SAE 101-2, 22-4
 -PX9842 COMPANION FLANGE

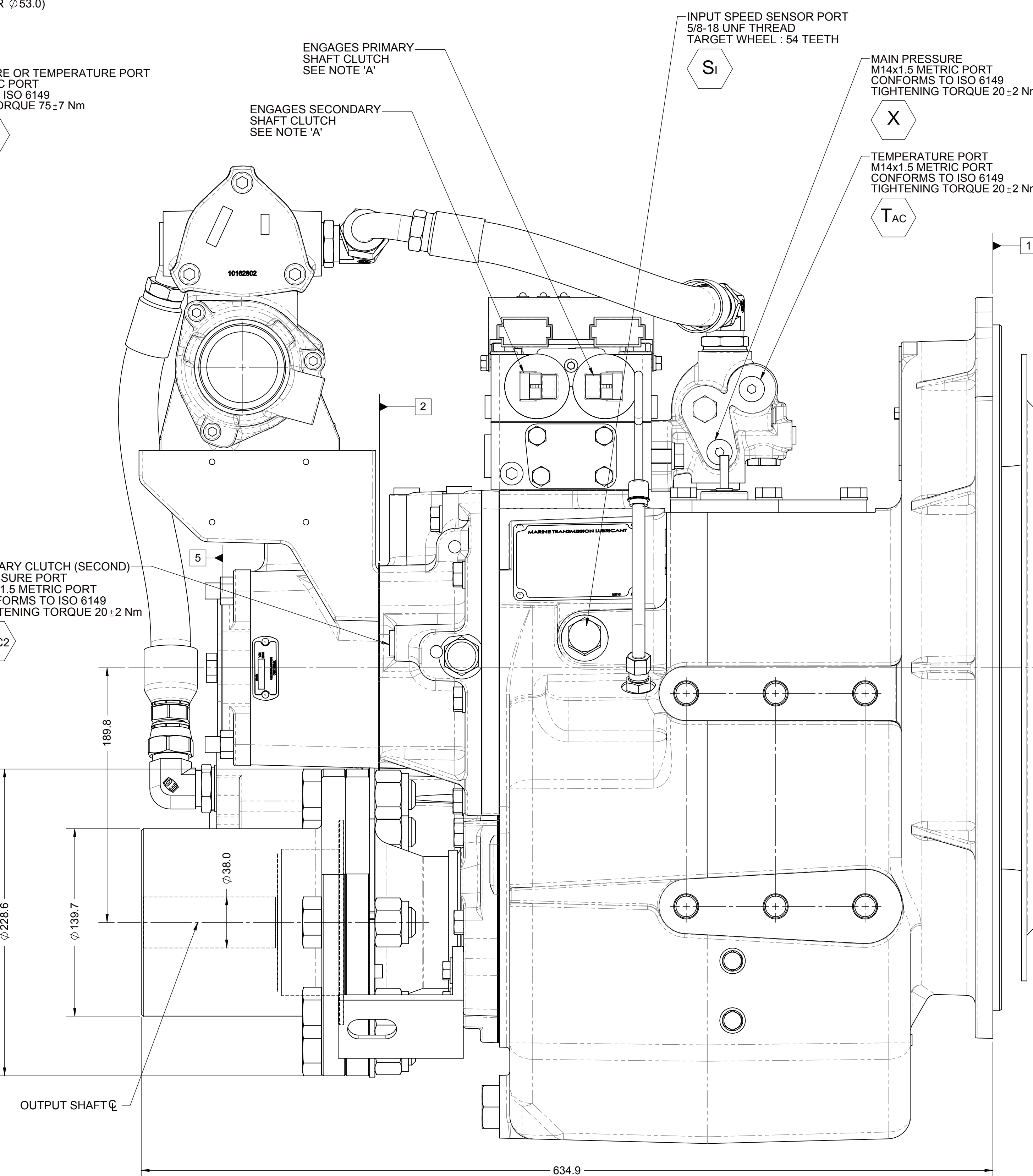
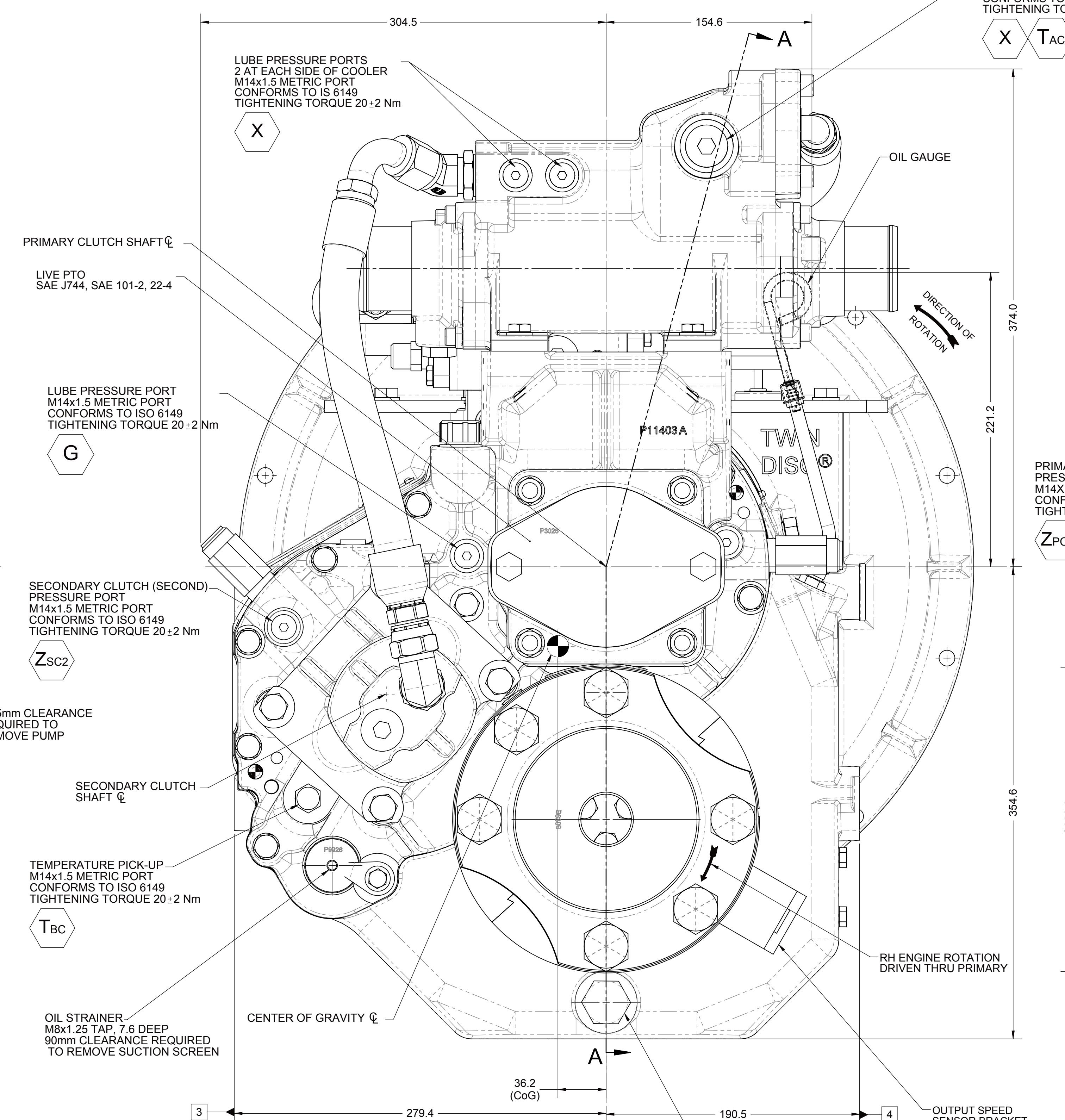
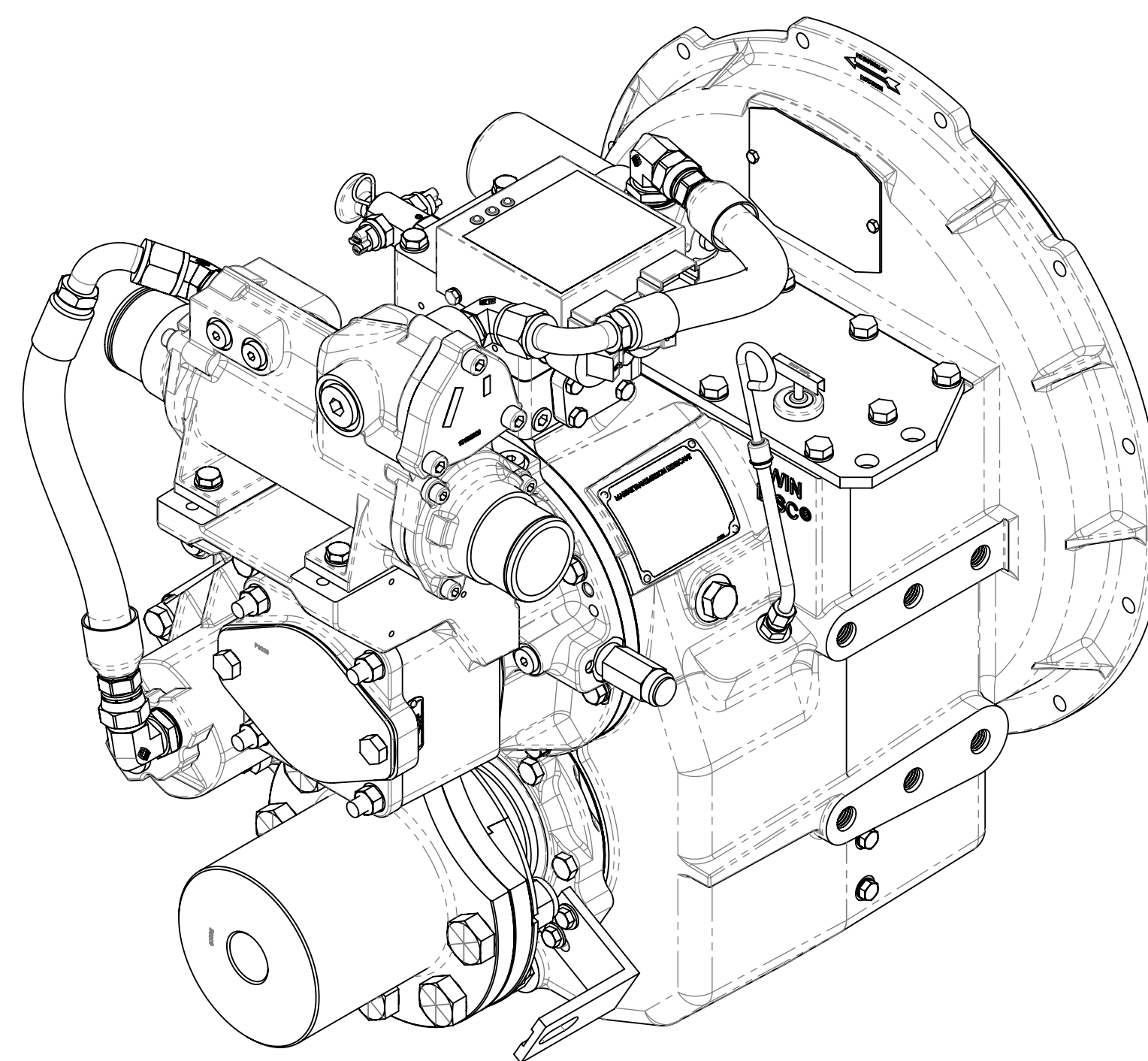
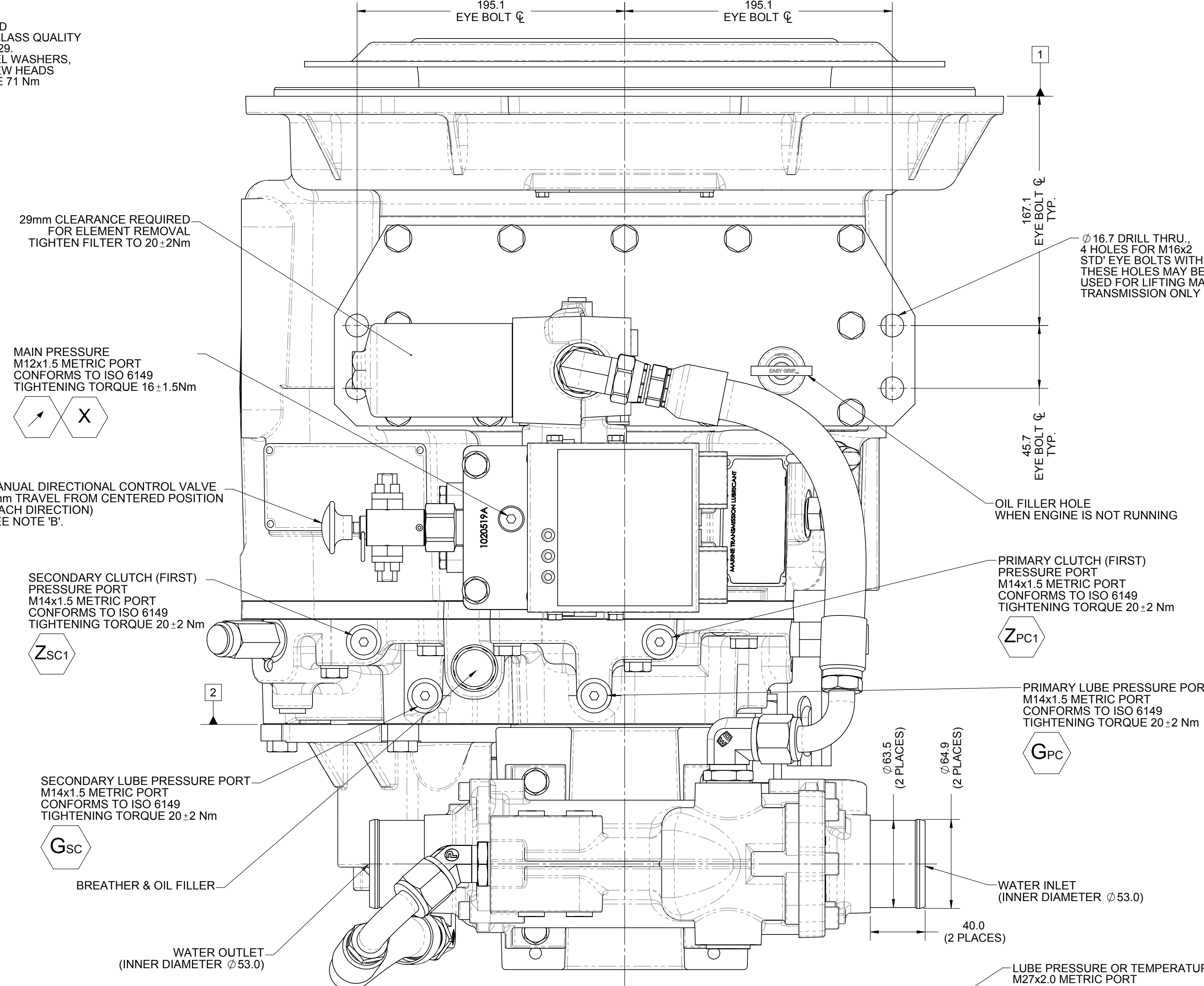
[illegible]