

ASD 8**ARNESON SURFACE DRIVE****BRONZE IN-LINE (ASD08B1L)**

- Bronze thrust assembly
- Internal lube oil reservoir
- Steering cylinder with external hoses and fittings
- Trim cylinder with external hoses and fittings
- Standard (or optional longer) fin
- Standard 25-tooth (or optional 26-tooth) splined propeller shaft
- Installation manual, owners manual and drive ball wrench (one per ship set)

**ACCESSORIES**

- Anode Kit
- Cylinder position indicator kits with gauge
- Hydraulic power steering system
- Gearbox adapter
- Driveline (cardan shaft)
- Companion (input) flange
- Tie-bar (mechanical or hydraulic – for multiple engine vessels)
- Inboard cylinder mounting kit
- Propeller

TECHNICAL DATA

Reduction Ratio/ Maximum Input Torque	1.00:1 1200 ft-lbs
Unit Weight	285 lbs
Overall Length	42 in
Nominal Shaft Diameter	2 in
Steering Angle Degree	40 degrees
Trim Angle Degree	15 degrees

ASD 8 IN-LINE SURFACE DRIVE SCHEMATICS

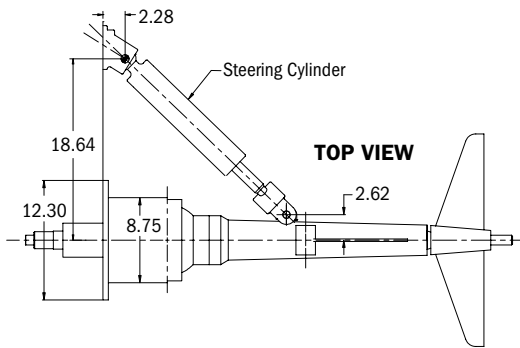

INPUT SHAFT DETAIL

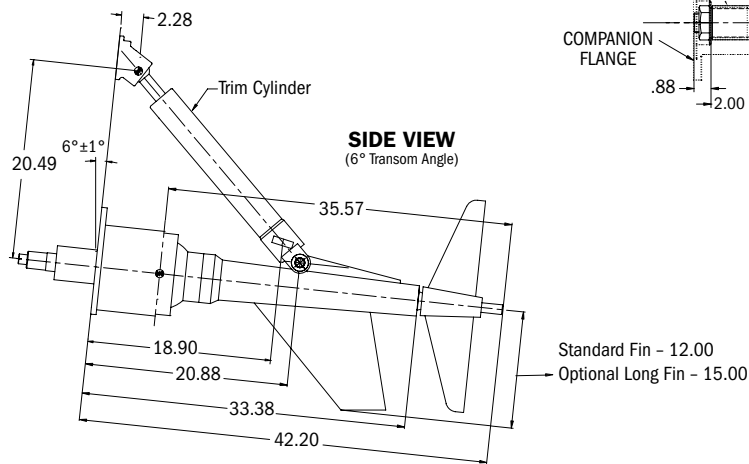
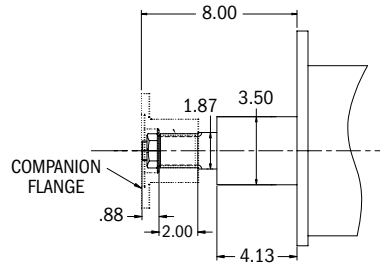

END VIEW
(Dimensions are Parallel with Transom)

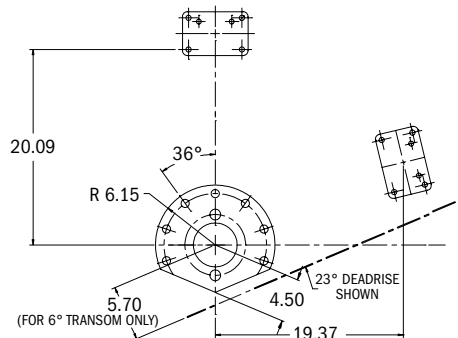

Since 1918, we've been putting horsepower to work by designing, engineering and manufacturing rugged-duty industrial products. Our products and our reputation are bolted to the most renowned engine manufacturers and equipment OEMs in the world. Our mission is to make boats, machines and off-highway vehicles more productive, more durable, more operator-friendly, and more cost-effective. From design and installation consultation through after-sale support, Twin Disc and its distributors are committed to your business. No one knows more about managing horsepower in more ways than Twin Disc.

- TRANSMISSIONS
- ELECTRONIC CONTROLS
- EXPRESS JOYSTICK SYSTEM®
- SAILDRIVES
- EXPRESS POSITIONING®
- ARNESON® SURFACE DRIVES
- MARINE CONTROL DRIVES
- ROLLA™ PROPELLERS
- THRUSTERS
- VETH PROPULSION SYSTEMS
- STEERING SYSTEMS
- RUDDERS
- TRIM TABS
- BLUEDRIVES
- PUMP DRIVES
- PTOS



Twin Disc, Incorporated
 Racine, Wisconsin 53403 USA
 Phone +1-262-638-4000
 Fax +1-262-638-4482
www.twindisc.com

Twin Disc, Incorporated reminds users of these products that their safe operation depends on use in compliance with engineering information provided in our catalog. Users are also reminded that safe operation depends on proper installation, operation and routine maintenance and inspection under prevailing conditions. It is the responsibility of users (and not Twin Disc, Incorporated) to provide and install guards or safety devices which may be required by recognized safety standards or by the Occupational Safety and Health Act of 1970 and its subsequent provisions.